

**THERMISTOR
REPLACEMENT KIT****INSTALLATION INSTRUCTIONS FOR THERMISTOR KITS USED ON
LGM/LCM/LGT/LCT/LHT/LDT024-300 PACKAGED UNITS****Shipping and Packing List****Package 1 of 1 contains:**

- 4- Thermistors with wire harnesses

⚠ WARNING**To prevent serious injury or death:**

- 1- Lock-out/tag-out before performing maintenance.
- 2- If system power is required (e.g., smoke detector maintenance), disable power to blower, remove fan belt where applicable, and ensure all controllers and thermostats are set to the "OFF" position before performing maintenance.
- 3- Always keep hands, hair, clothing, jewelry, tools, etc., away from moving parts.

Check packaging for shipping damage. Contact the last carrier immediately if any shipping damage is found.

Application

Units are equipped with factory-installed thermistors located on different points on the refrigerant circuit. The thermistors provide the Unit Controller with constant temperature readings. These temperatures are used as feedback in certain modes of unit operation. In addition, the Unit Controller uses these temperatures to initiate alarms such as loss of outdoor or indoor coil airflow and loss of charge.

Each thermistor must be specifically placed for proper unit operation and to initiate valid alarms. For proper locations and kit application, see table 1 through 6 for LGM/LCM units and tables 7 through 13 for LGT/LCT/LHT/LDT units.

Note - Four thermistors are provided in each kit but not all thermistors are used in each application.

**TABLE 1
LGM/LCM036, 048**

Cat. No.	Ass'y. No.	Sensor Yellow	Figure
22J06	623049-01	RT46	1
22J07	623049-02	RT42	1
22J08	623049-03	RT48	3
22J09	623049-04	RT44	3

**TABLE 2
LGM/LCM060, 074**

Cat. No.	Ass'y. No.	Sensor Yellow	Figure
22J06	623049-01	RT46	2
22J07	623049-02	RT42	2
22J08	623049-03	RT48	3
22J09	623049-04	RT44	3

**TABLE 3
LGM/LCM092, 102, 120, 150**

Cat. No.	Ass'y. No.	Sensor Yellow, Blue	Figure
22J06	623049-01	RT46, 47	4
22J07	623049-02	RT42, 43	4
22J08	623049-03	RT48, 49	6
22J09	623049-04	RT44, 45	5

**TABLE 4
LGM/LCM156, 180**

Cat. No.	Ass'y. No.	Sensor Yel, Blue, Red	Figure
22J06	623049-01	RT46, 47, 50	7
22J07	623049-02	RT42, 43, 54	7
22J08	623049-03	RT48, 49, 52	9
22J09	623049-04	RT44, 45, 56	9

**TABLE 5
LGM/LCM210**

Cat. No.	Ass'y. No.	Sensor Yel, Blu, Red, Grn	Figure
22J06	623049-01	RT46, 47, 50, 51	8
22J07	623049-02	RT42, 43, 54, 55	8
22J08	623049-03	RT48, 49, 52, 53	10
22J09	623049-04	RT44, 45, 56, 57	10

**TABLE 6
LGM/LCM240, 300**

Cat. No.	Ass'y. No.	Sensor Yel, Blu, Red, Grn	Figure
22J06	623049-01	RT46, 47, 50, 51	8
22J07	623049-02	RT42, 43, 54, 55	8
22J08	623049-03	RT48, 49, 52, 53,	11
22J09	623049-04	RT44, 45, 56, 57	11

WARNING

Improper installation, adjustment, alteration, service or maintenance can cause property damage, personal injury or loss of life. Installation and service must be performed by a licensed professional HVAC installer or equivalent, service agency, or the gas supplier.

CAUTION

As with any mechanical equipment, contact with sharp sheet metal edges can result in personal injury. Take care while handling this equipment and wear gloves and protective clothing.

TABLE 7
LGT/LCT/LHT/LDT024, 036, 048, 060, 072

Unit	Cat. No.	Ass'y. No.	Sensor Yellow	Figure
LHT/LDT060	22J06	623049-01	RT46	12
LHT/LDT 024, 036, 048	22J06	623049-01	RT46	13
LGT/LCT036, 048, 060, 072	22J06	623049-01	RT46	14
LHT/LDT048	22J08	623049-03	RT48	15
LHT/LDT060	22J08	623049-03	RT48	16
LHT/LDT 024, 036	22J08	623049-03	RT48	17
LGT/LCT036, 048, 060, 072	23V50	623049-05	RT48	18

TABLE 8
LGT/LCT156

Cat. No.	Ass'y. No.	Sensor Yellow, Blue	Figure
22J06	623049-01	RT46, 47	19
23V50	623049-05	RT48, 49	22

TABLE 9
LGT/LCT180

Cat. No.	Ass'y. No.	Sensor Yellow, Blue, Red	Figure
22J06	623049-01	RT46, 47, 50	20
23V50	623049-05	RT48, 49, 52	23

TABLE 10
LGT/LCT210, 240, 300

Cat. No.	Ass'y. No.	Sensor Yel, Blu, Red, Grn	Figure
22J06	623049-01	RT46, 47, 50, 51	21
23V50	623049-05	RT48, 49, 52, 53	24

TABLE 11
LGT/LCT092, 102, 120, 150

Cat. No.	Ass'y. No.	Sensor Yellow, Blue	Figure
22J06	623049-01	RT46, 47	25
23V50	623049-05	RT48, 49	26

TABLE 12
LHT/LDT078, 092, 102, 122, 150

Cat. No.	Ass'y. No.	Sensor Yellow, Blue	Figure
22J06	623049-01	RT46, 47	27
22J08	623049-03	RT48, 49	28

TABLE 13
LHT/LDT156, 180, 240

Cat. No.	Ass'y. No.	Sensor Yellow, Blue	Figure
22J06	623049-01	RT46, 47	29
22J08	623049-03	RT48, 49	30

LGM/LCM036 & 048
THREE-ROW EVAPORATOR COIL
(VIEW FROM FRONT SIDE OF UNIT)
RT42 & 46

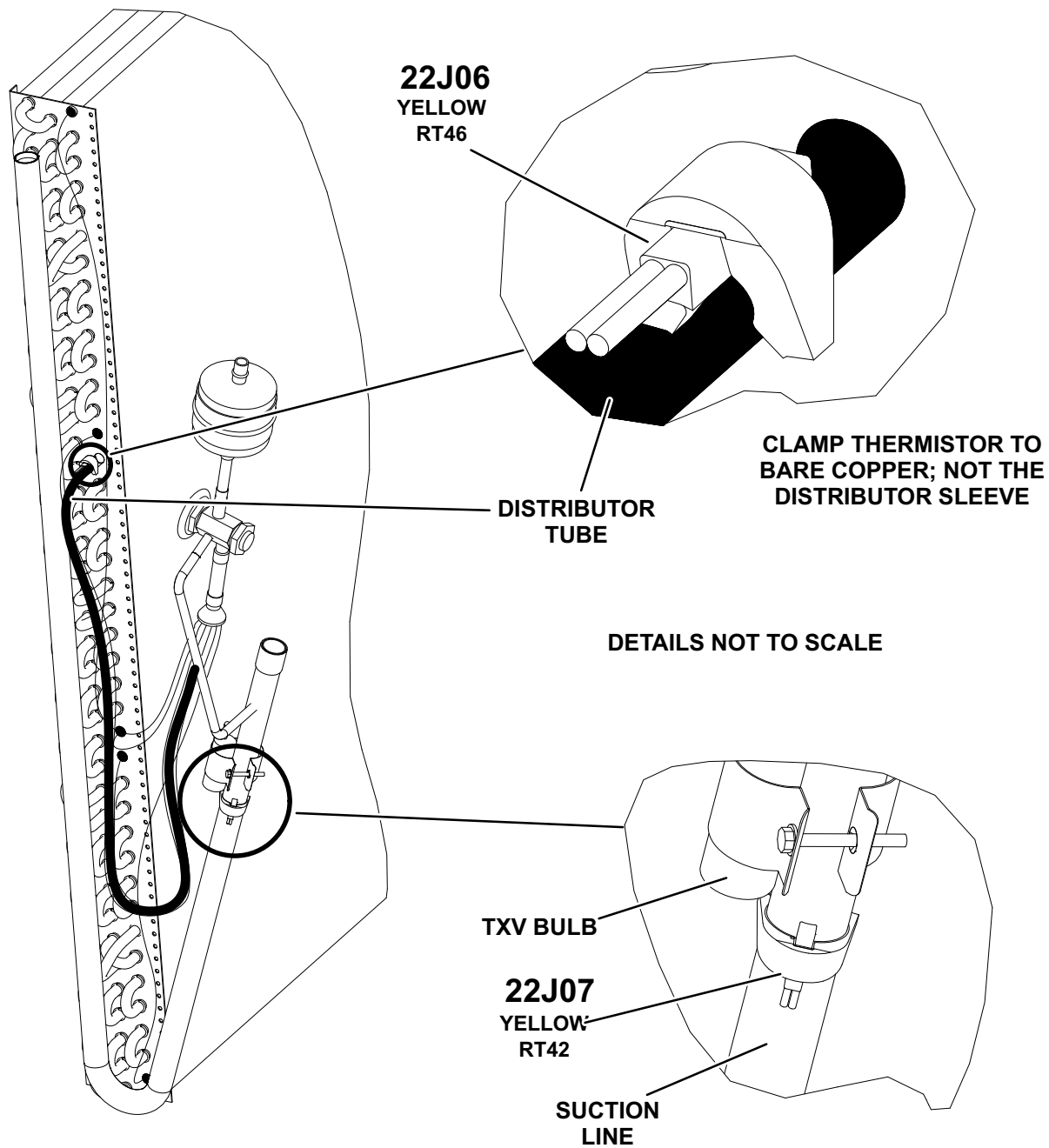

FIGURE 1

**LGM/LCM060 & 074
FOUR-ROW EVAPORATOR COIL
(VIEW FROM FRONT SIDE OF UNIT)
RT42 & 46**

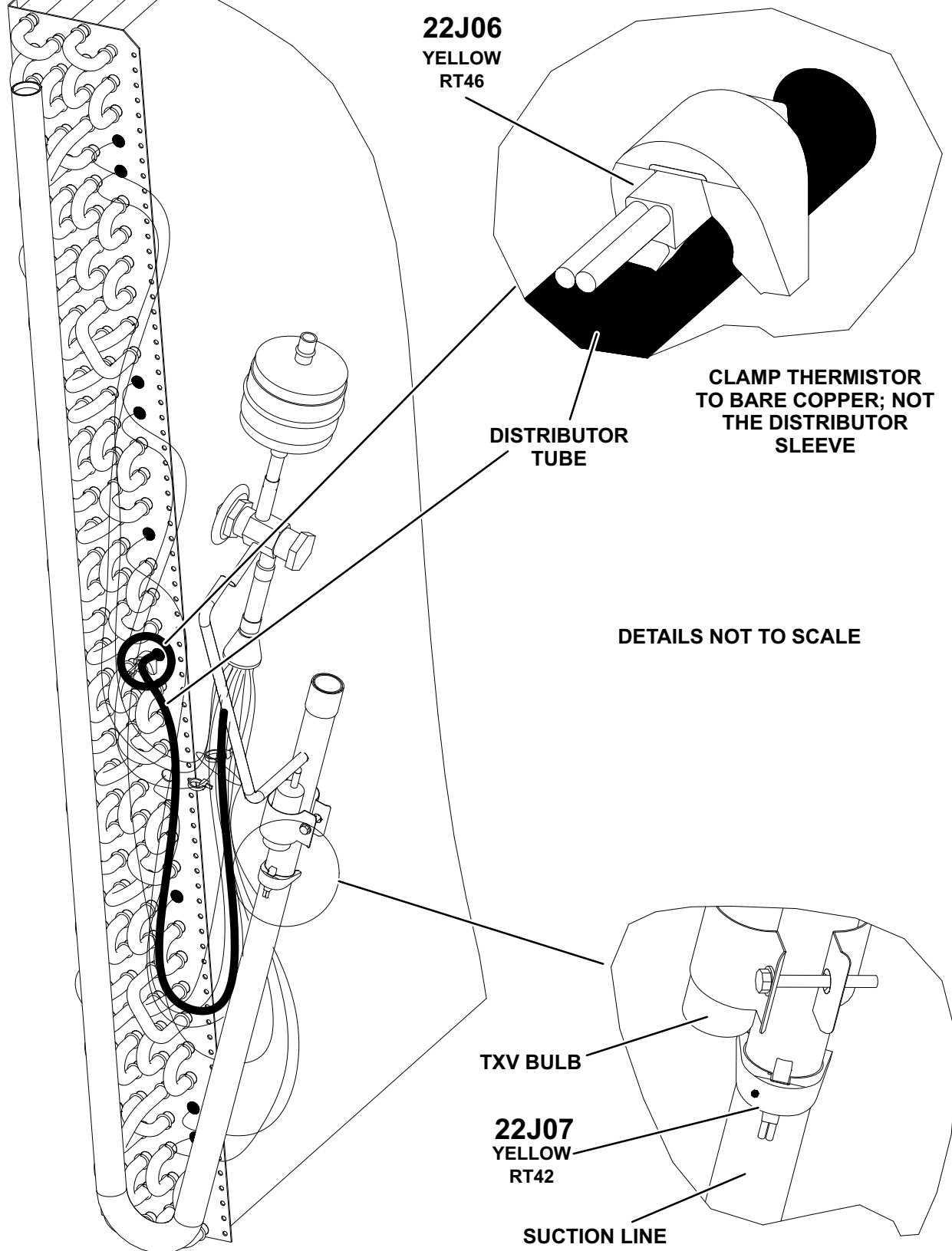

FIGURE 2

**LGM/LCM036, 048, 060, 074
CONDENSER COIL
(VIEW FROM FRONT SIDE OF UNIT)
RT44 & RT48**

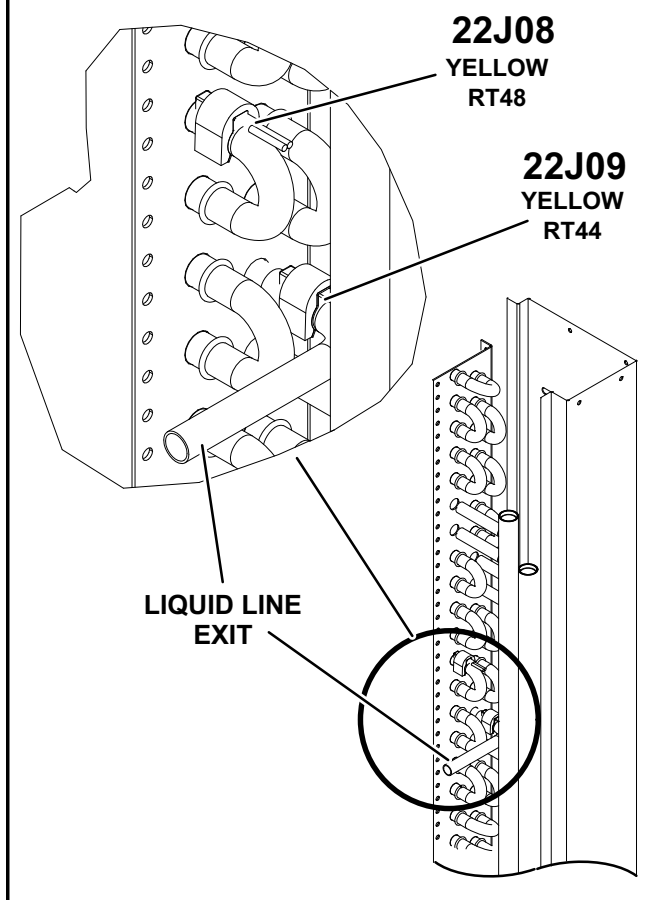

FIGURE 3

LGM/LCM092-150
CONDENSER COIL
(VIEW FROM FRONT SIDE OF UNIT)
RT42, 43, 46, 47

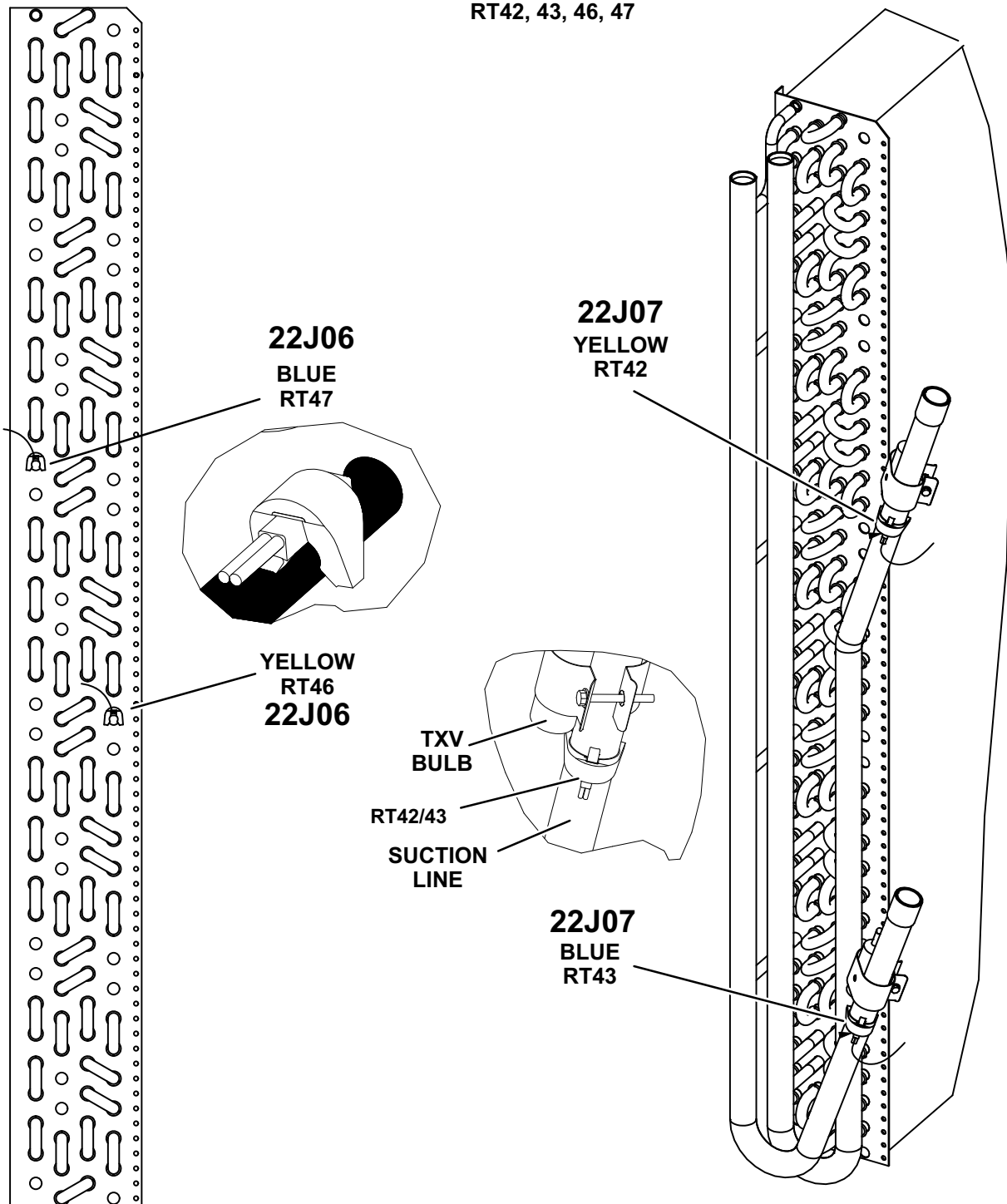
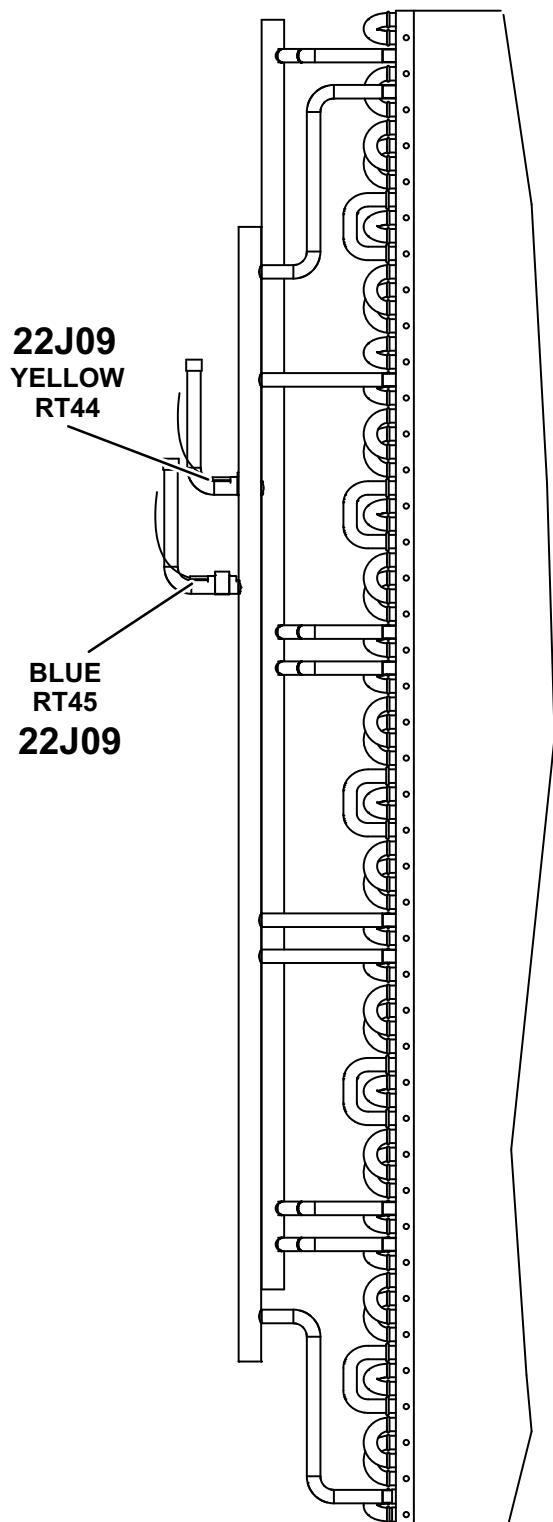

FIGURE 4

LGM/LCM092, 102, 120, 150
(VIEW FROM FRONT SIDE OF UNIT)
RT44 & 45

092, 102 CONDENSER COIL-
BEFORE SEPTEMBER 2022

092, 102 CONDENSER COIL
AFTER SEPTEMBER 2022
AND
120, 150 CONDENSER COIL



RT44 & 45

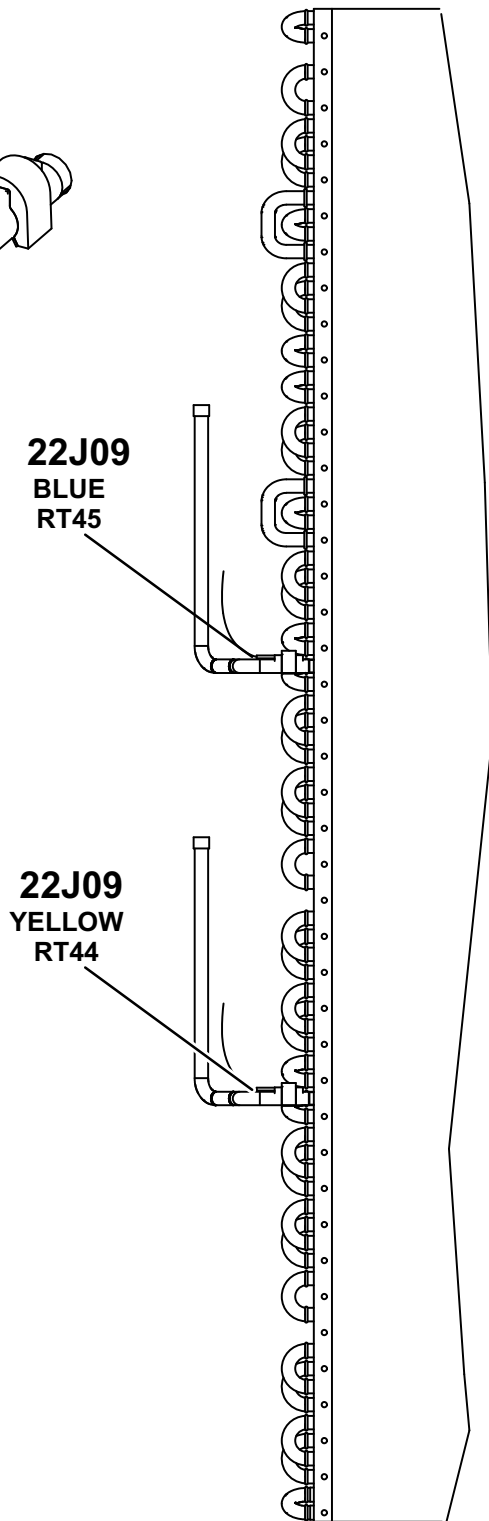
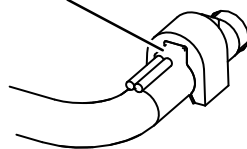

FIGURE 5

**LGM/LCM092, 102, 120, 150
(VIEW FROM FRONT SIDE OF UNIT)
RT48 & 49**

092, 102 CONDENSER COIL

120, 150 CONDENSER COIL

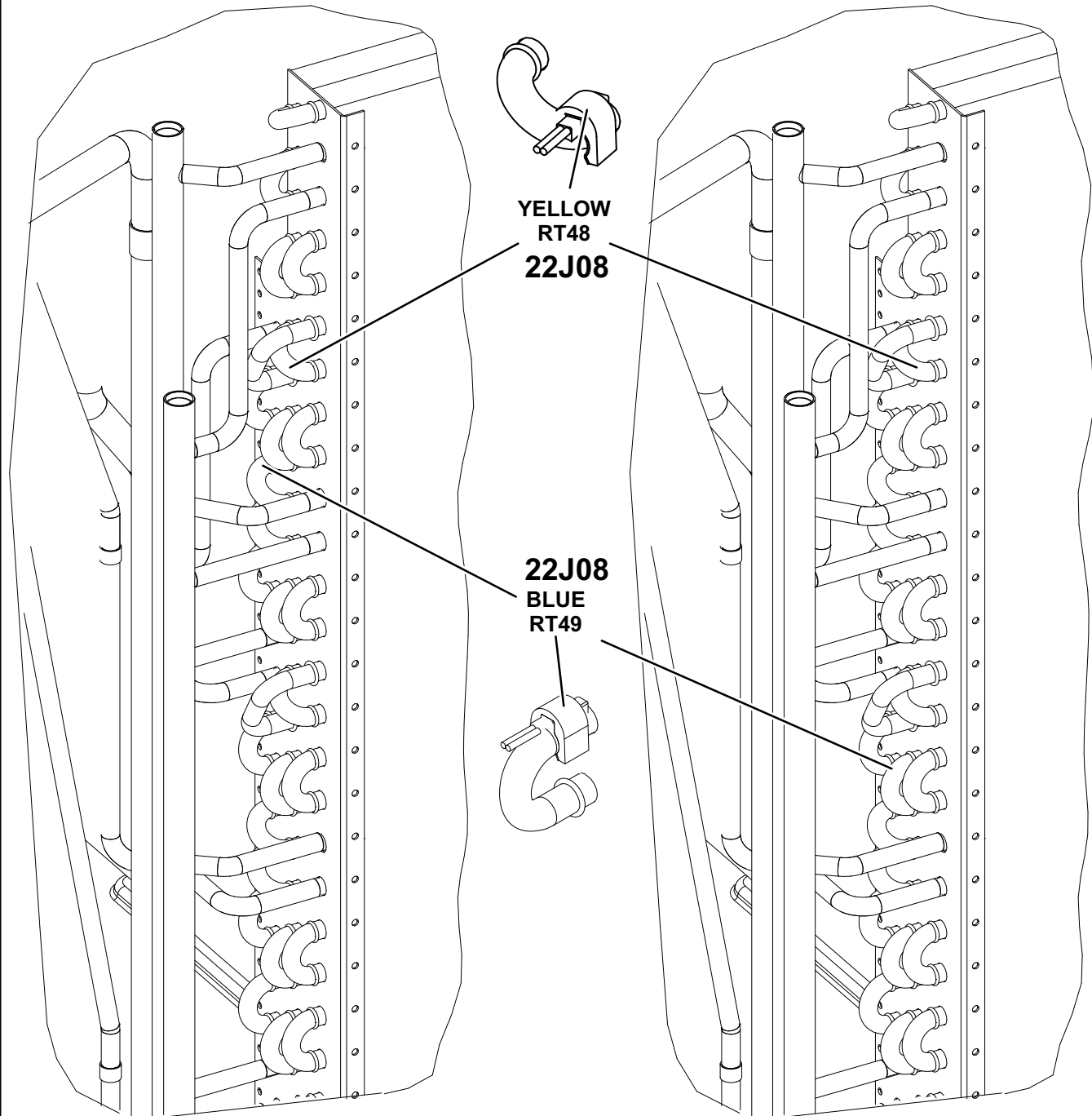

FIGURE 6

**LGM/LCM156, 180
THREE-ROW EVAPORATOR COIL
RT42, RT43, RT46, RT47, RT50, RT54**

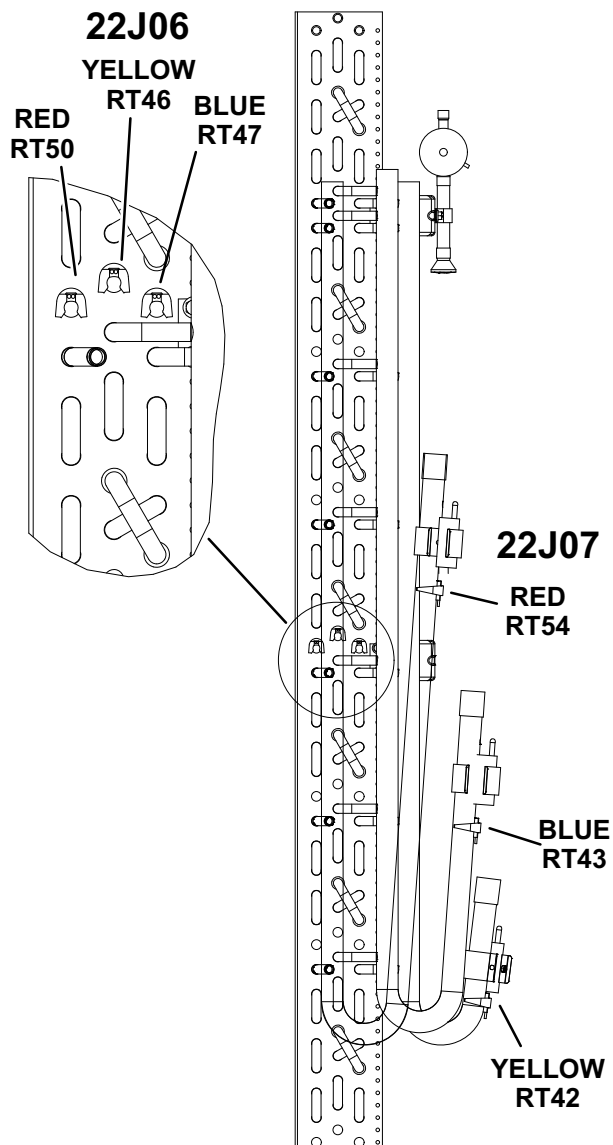

FIGURE 7

**LGM/LCM210, 240, 300
FOUR-ROW EVAPORATOR COIL
RT42, RT43, RT46, RT47, RT50, RT51, RT54, RT55**

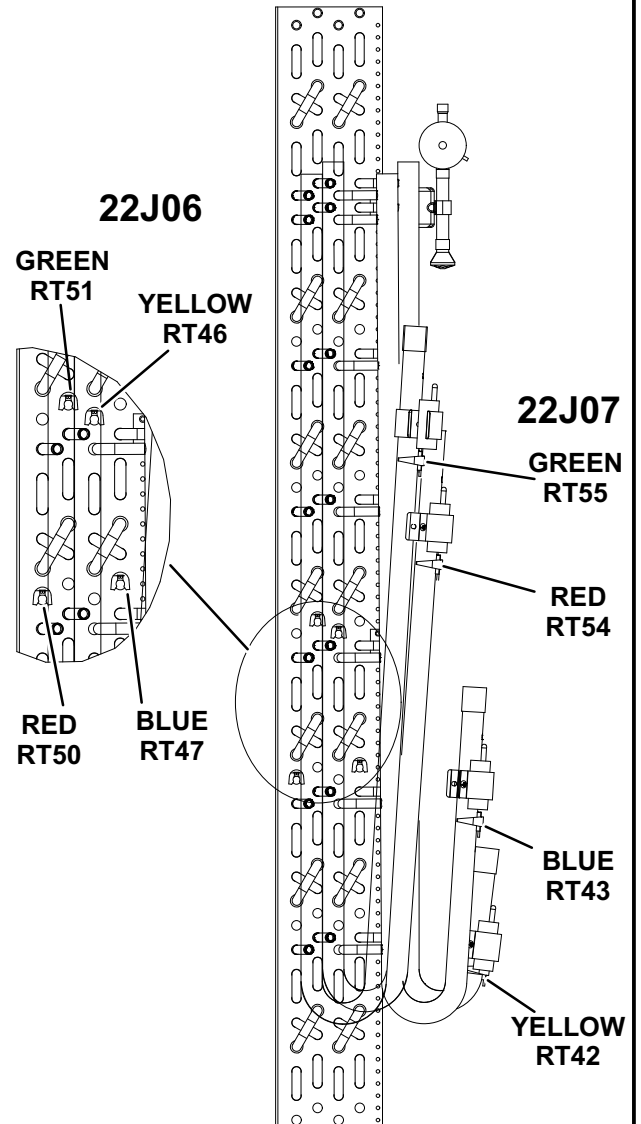

FIGURE 8

LGM/LCM156, 180
CONDENSOR COIL
RT44, RT45, RT48, RT49, RT52, RT56

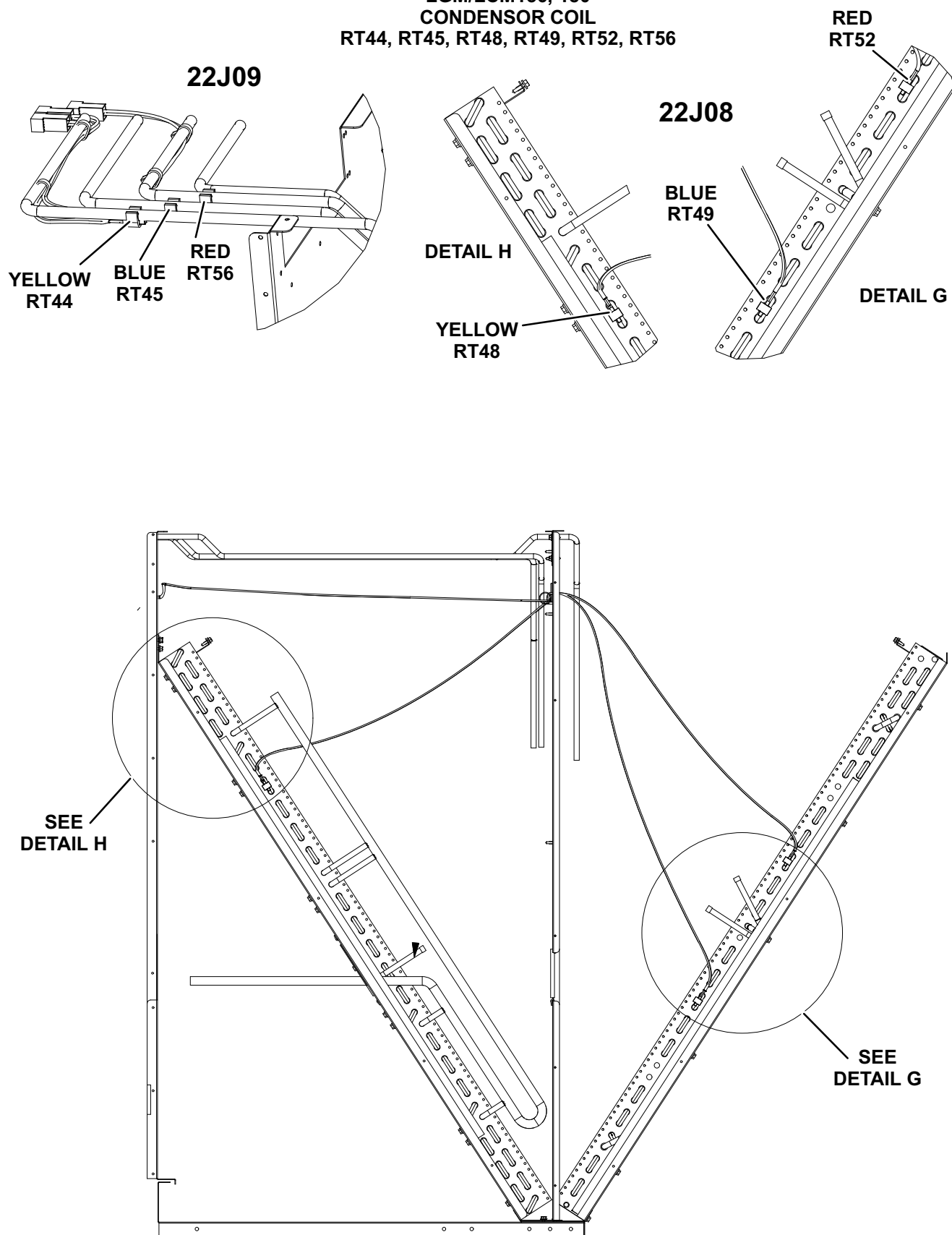

FIGURE 9

**LGM/LCM210
CONDENSOR COIL
RT44, RT45, RT48, RT49, RT52, RT53, RT56, RT57**

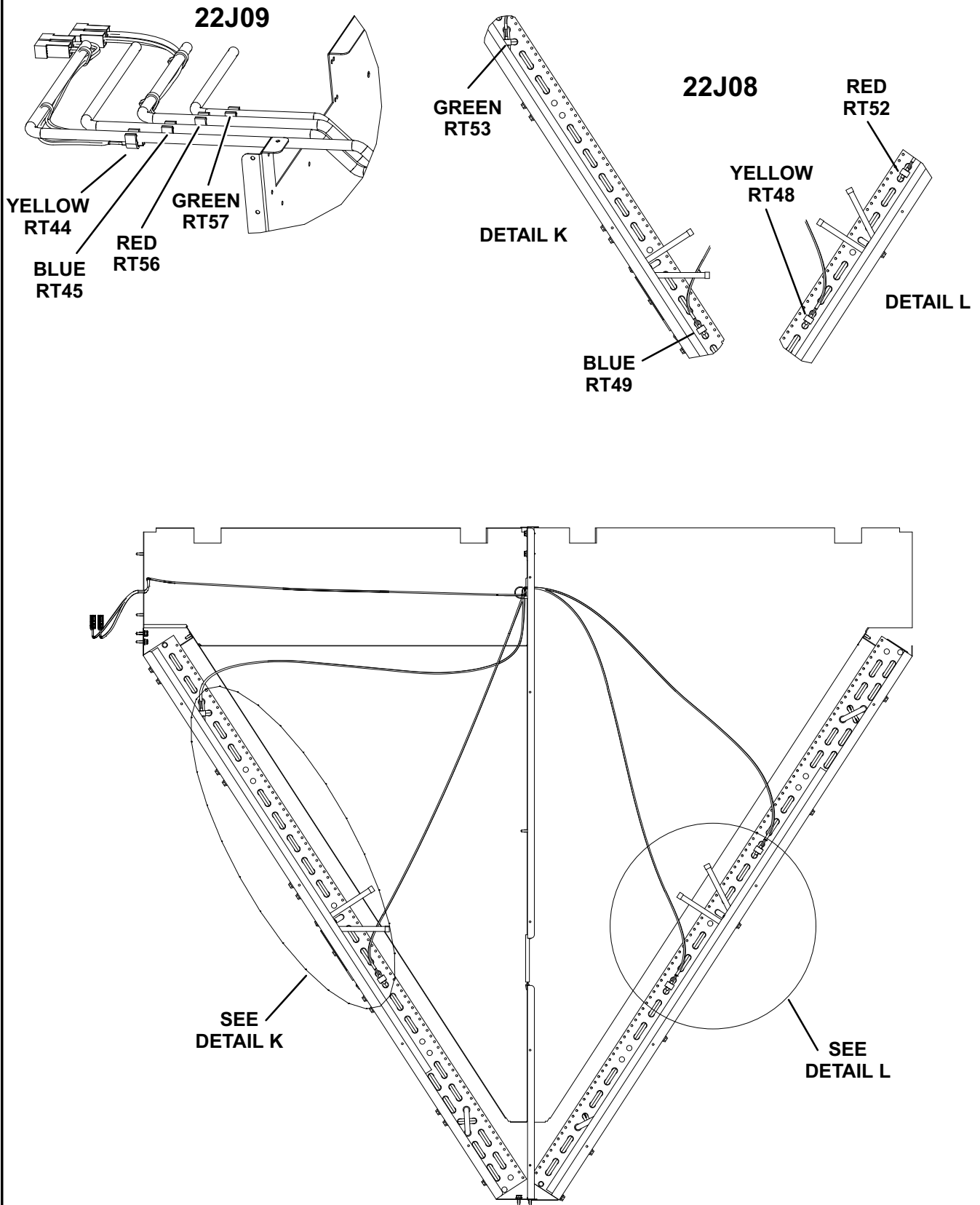

FIGURE 10

LGM/LCM240, 300
CONDENSOR COIL
RT44, RT45, RT48, RT49, RT52, RT53, RT56, RT57

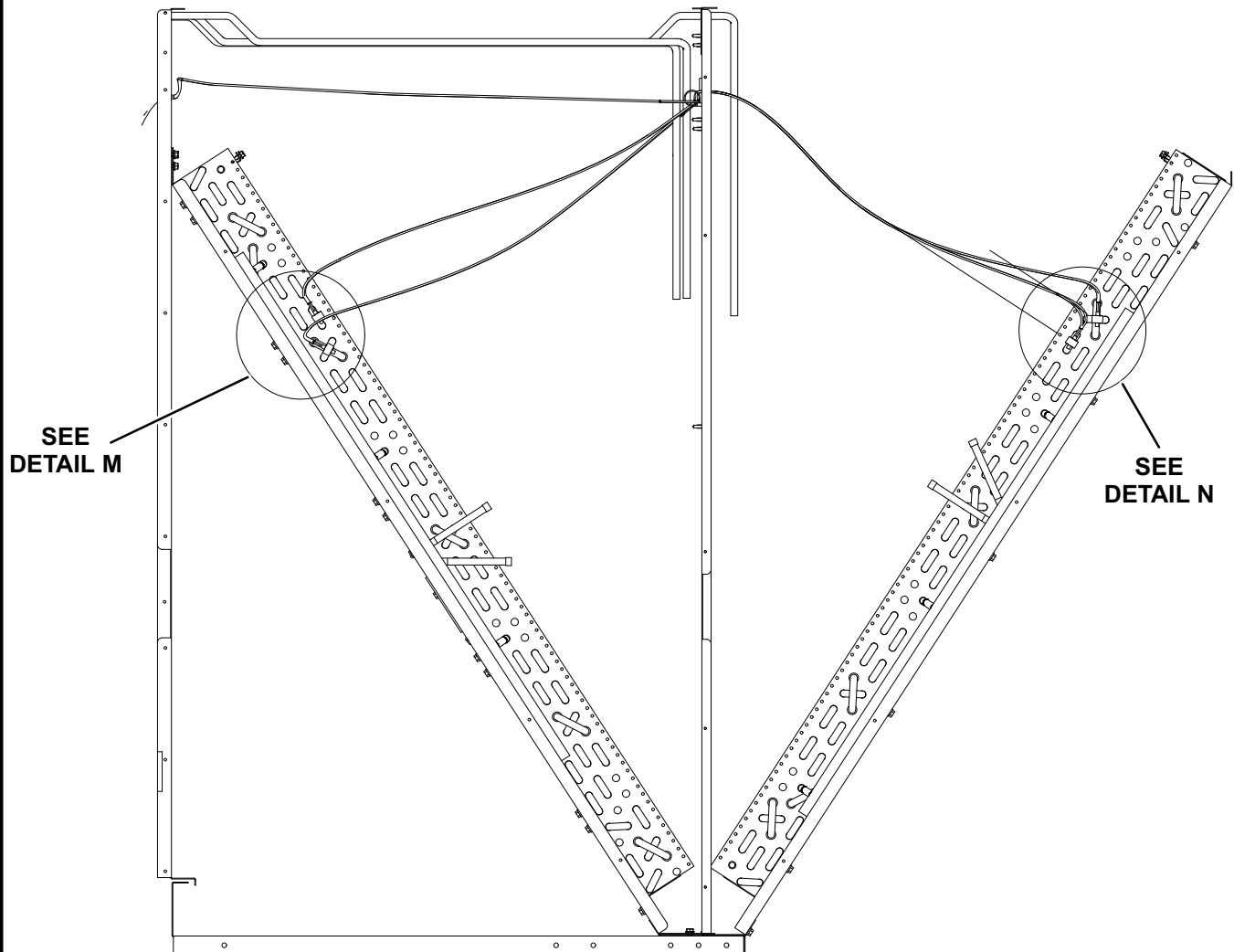
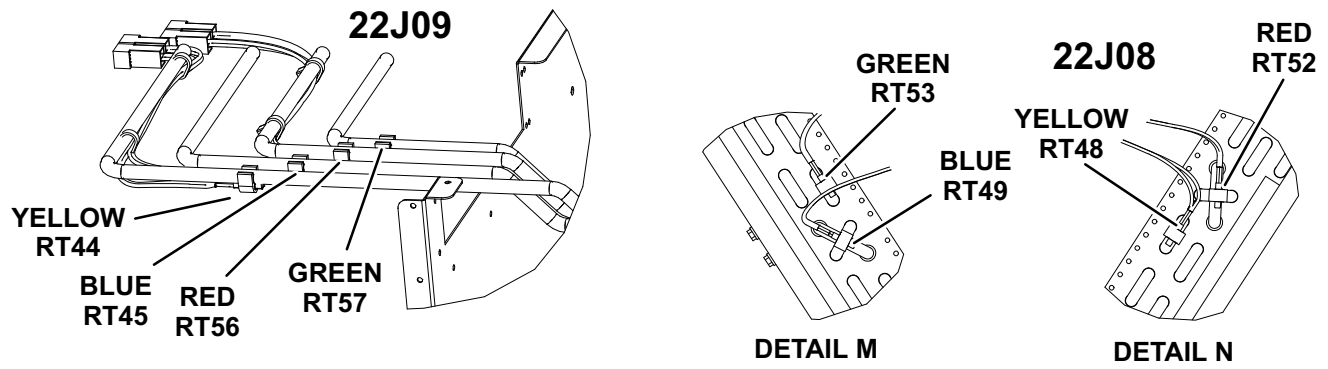

FIGURE 11

LHT/LDT060
INDOOR COIL
RT46

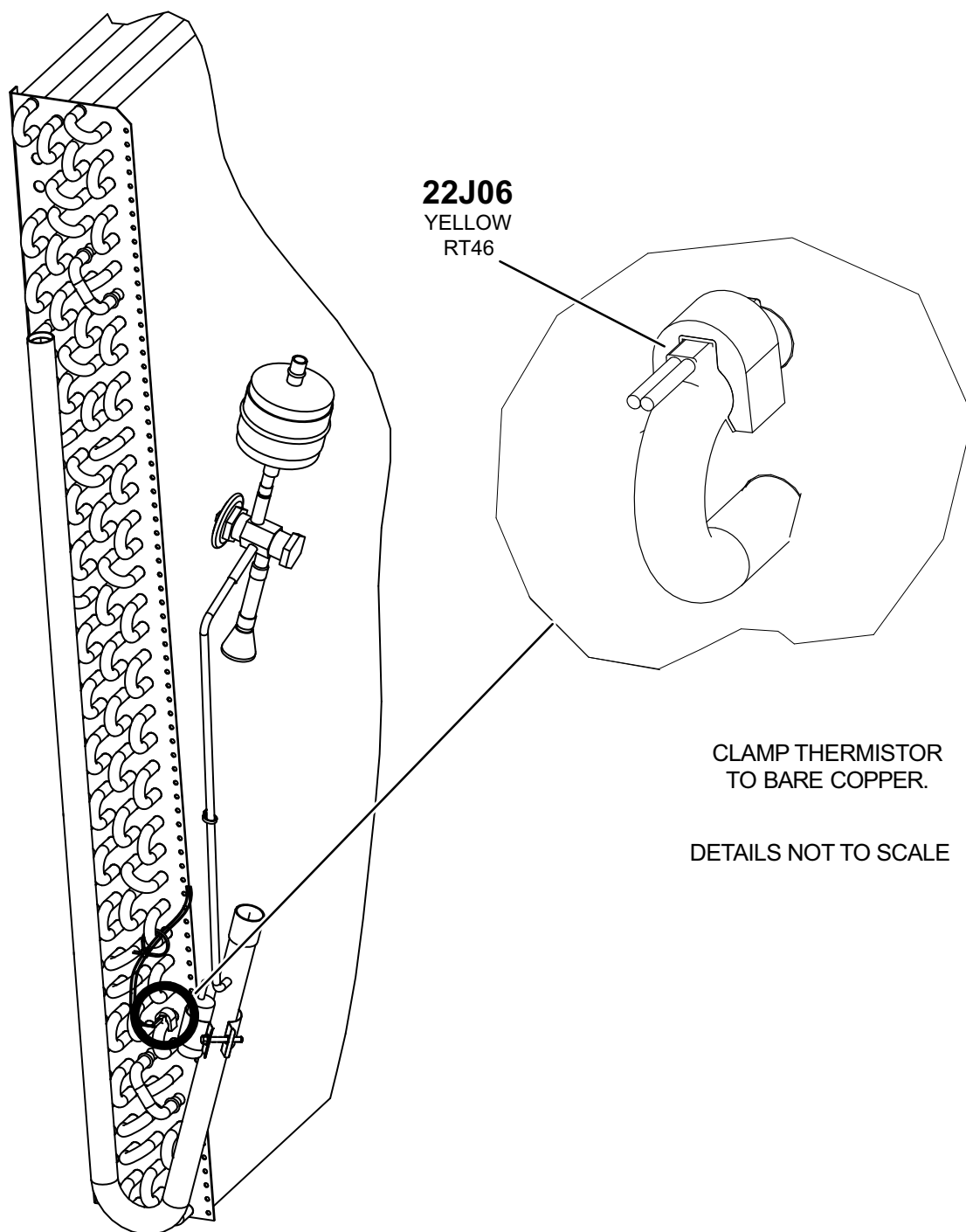

FIGURE 12

LHT/LDT024, 036, 048
INDOOR COIL
RT46

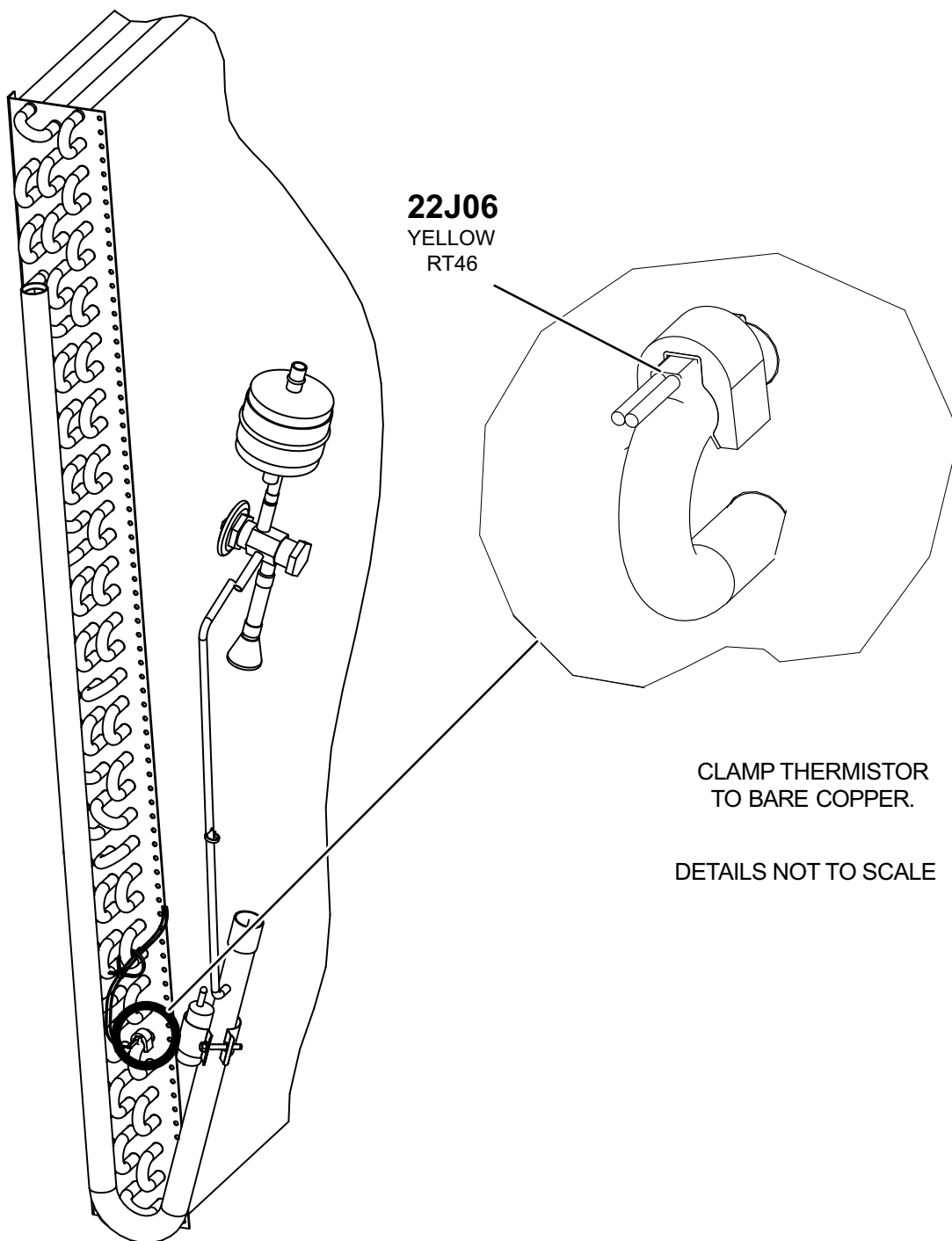
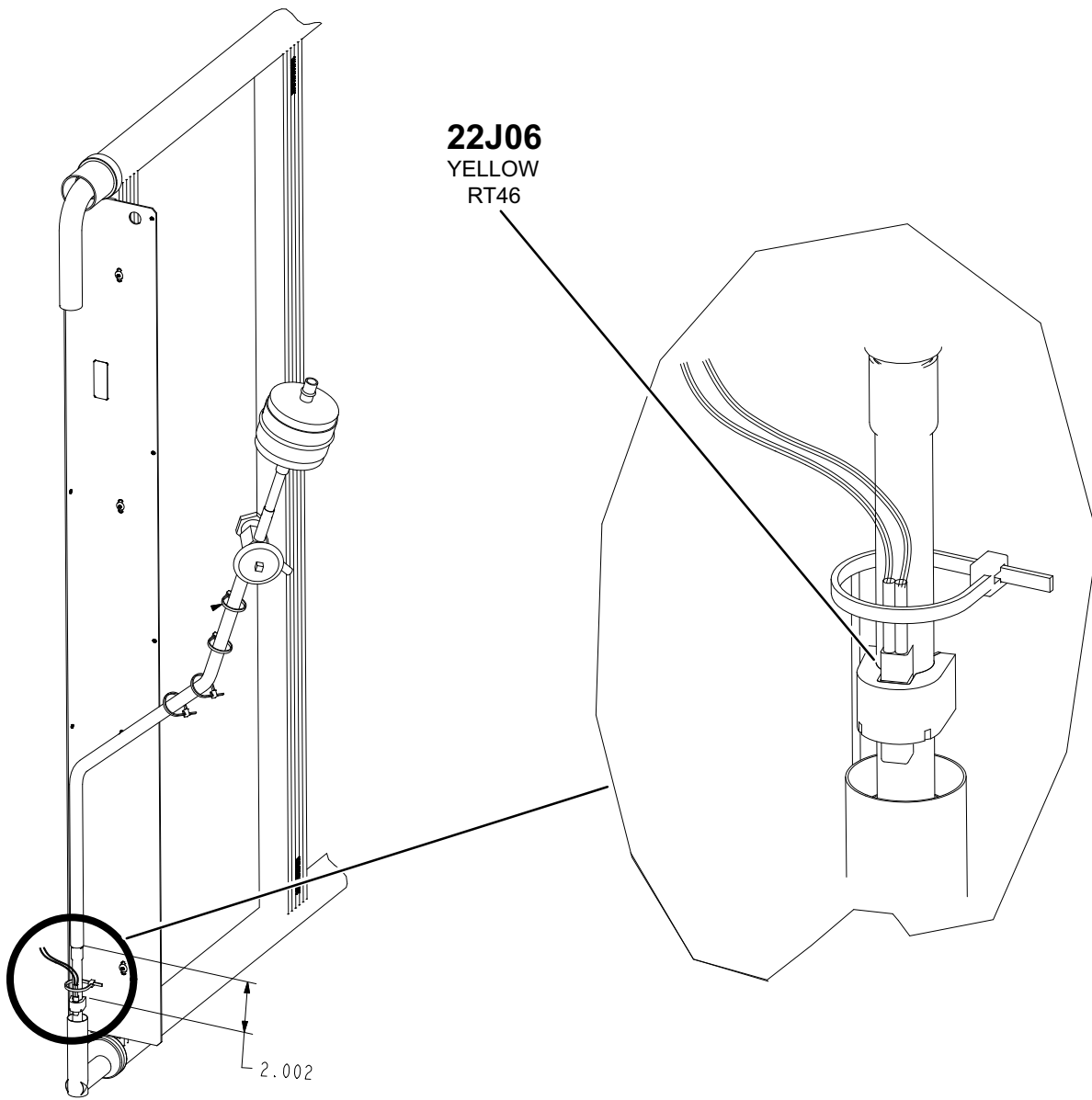

FIGURE 13

LGT/LCT 036, 048, 060, 072
EVAPORATOR COIL
RT46



CLAMP THERMISTOR
TO BARE COPPER.

DETAILS NOT TO SCALE

FIGURE 14

LHT/LDT048
OUTDOOR COIL
RT48

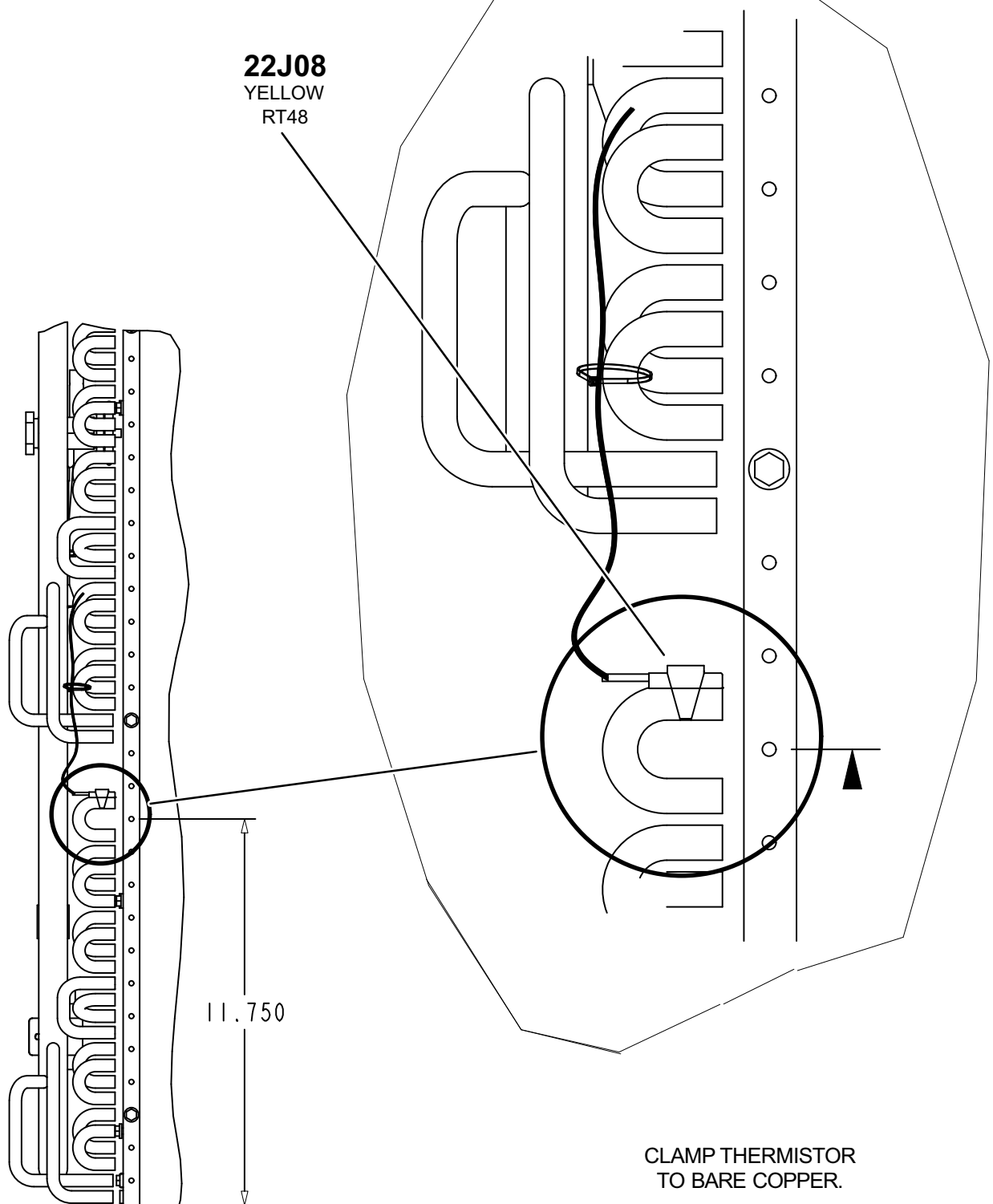

FIGURE 15

LHT/LDT060
OUTDOOR COIL
RT48

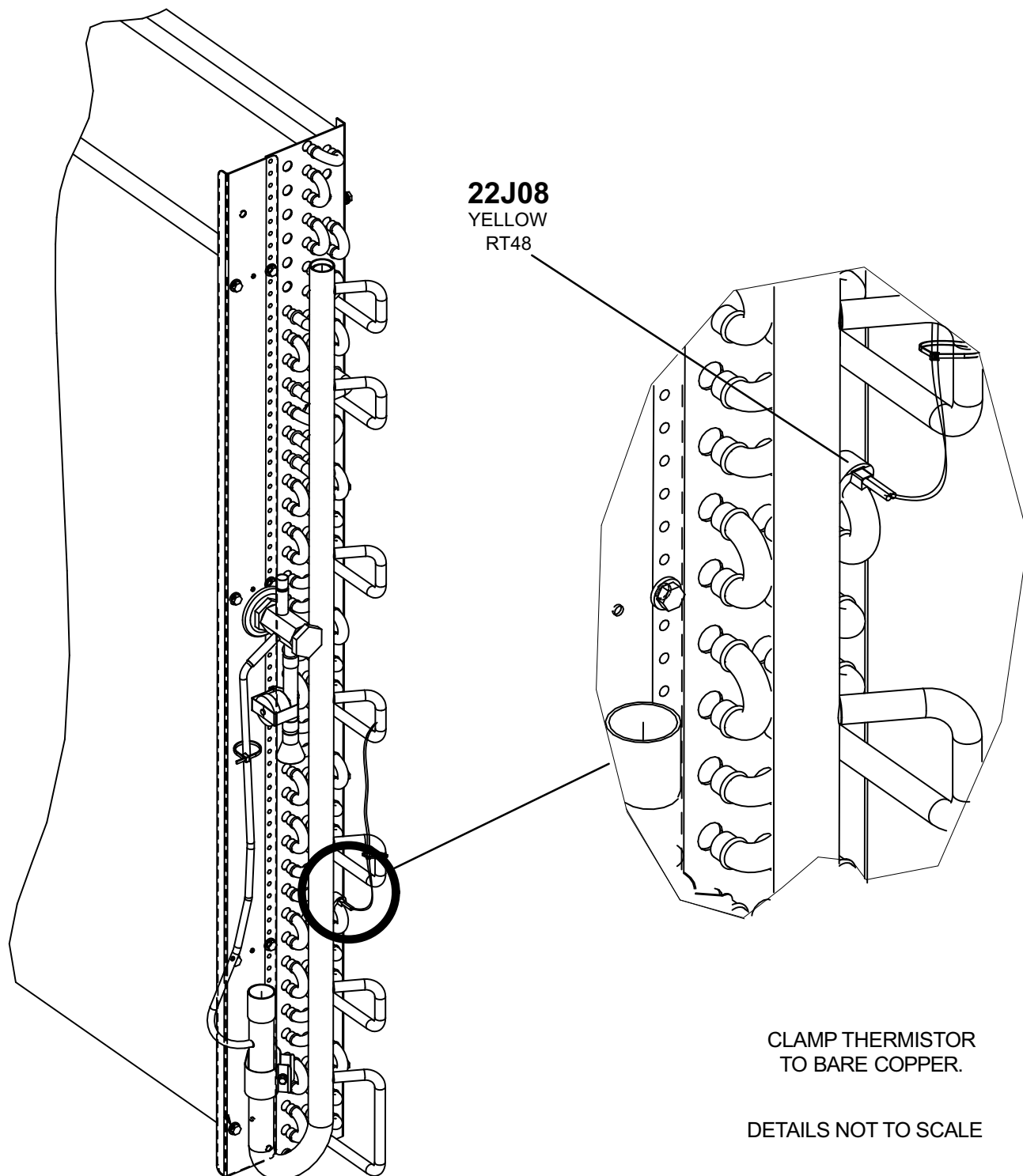

FIGURE 16

LHT/LDT024, 036
OUTDOOR COIL
RT48

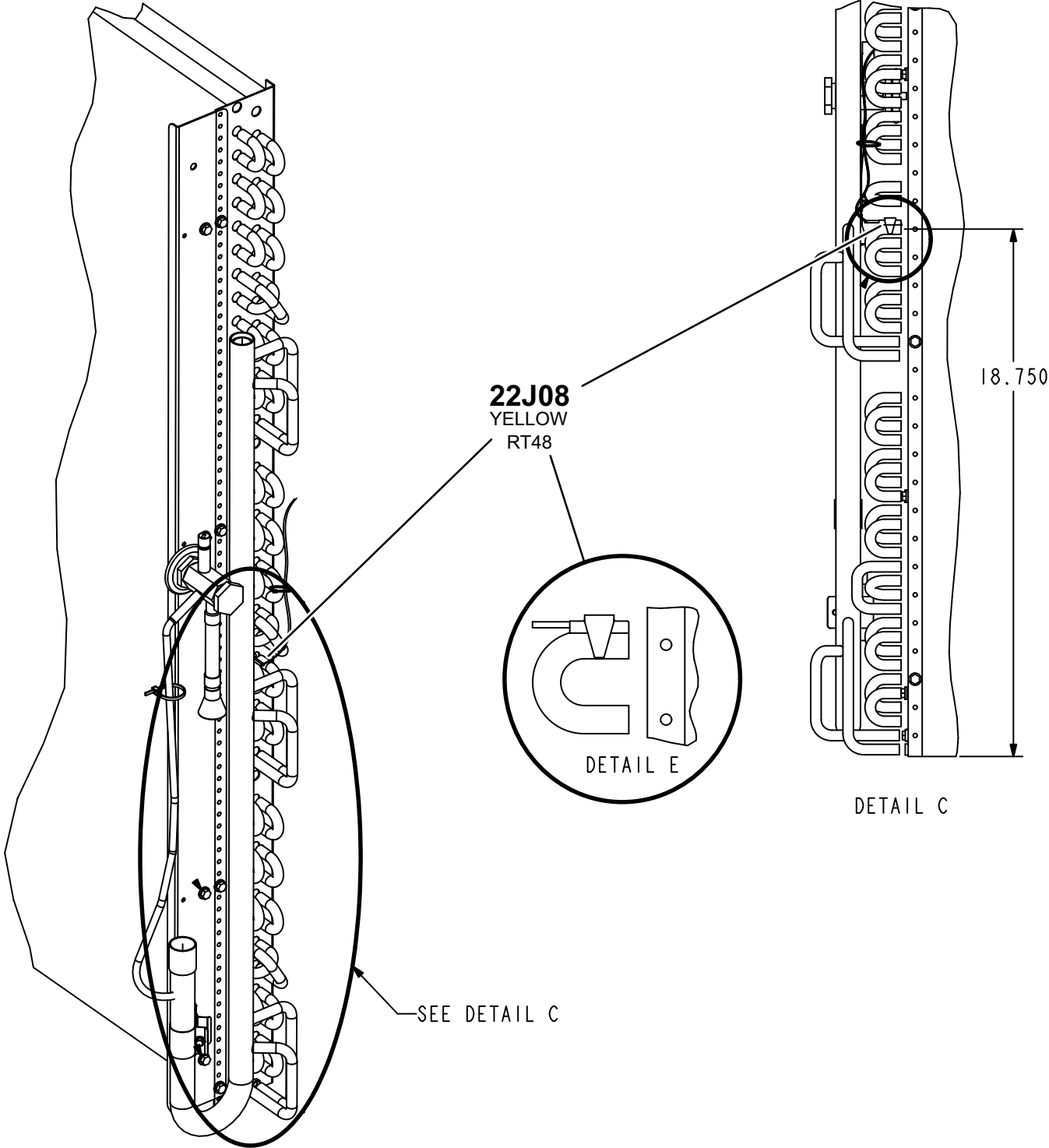

FIGURE 17
Page 18

LGT/LCT036, 048, 060, 072
CONDENSER COIL
RT48

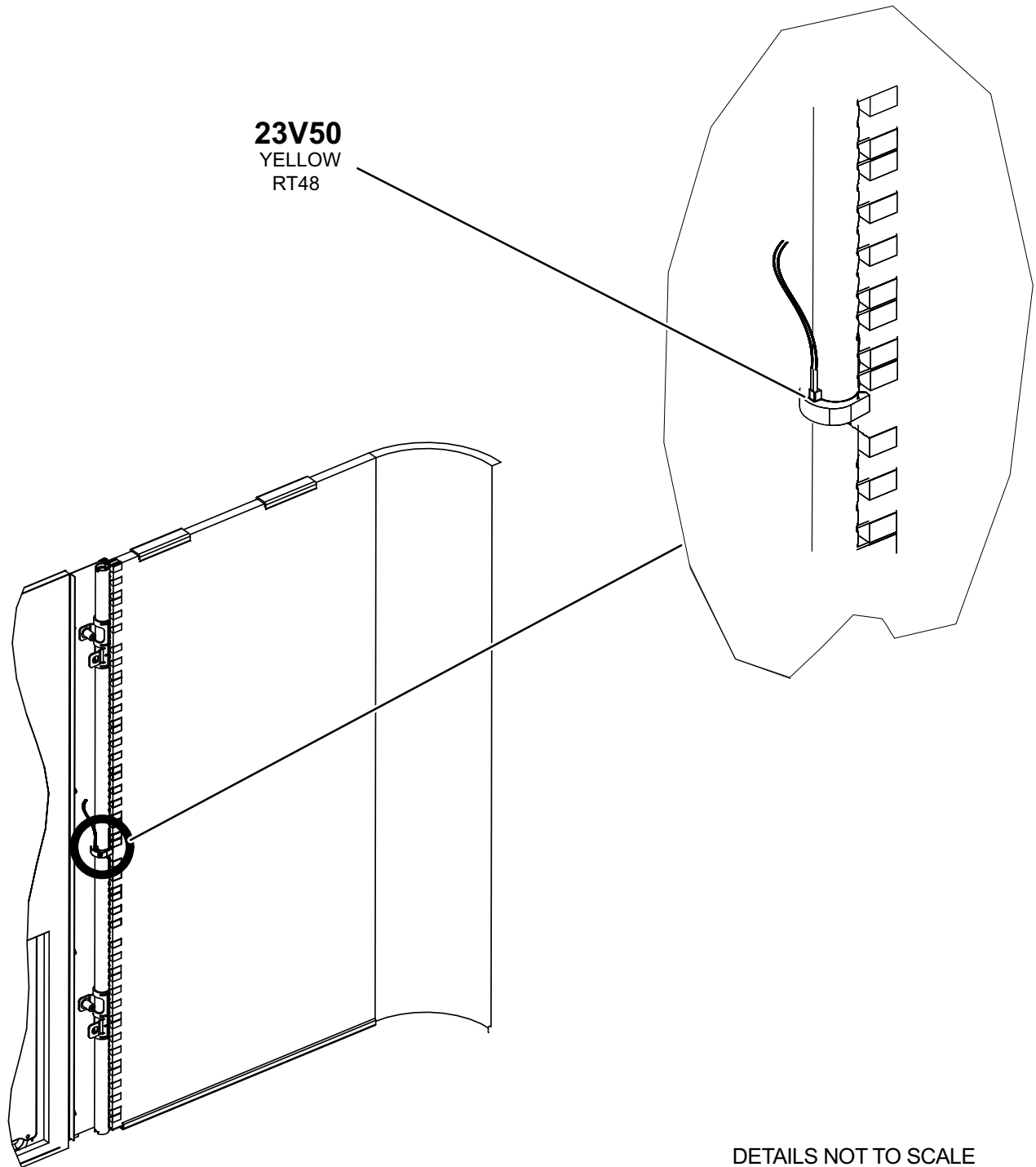

FIGURE 18

LGT/LCT156
EVAPORATOR COIL
(RT46, 47)

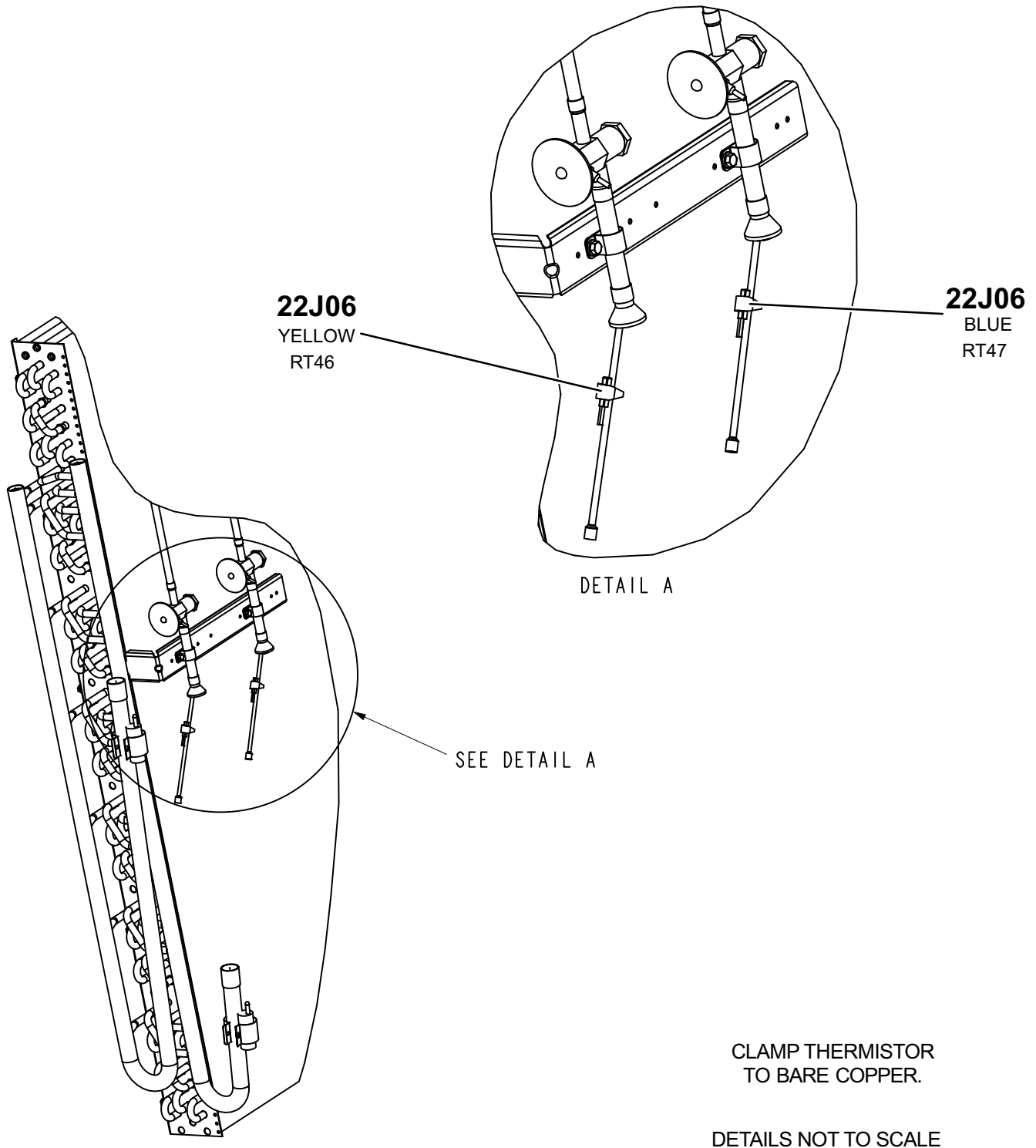

FIGURE 19

LGT/LCT180
EVAPORATOR COIL
RT46, 47, 50

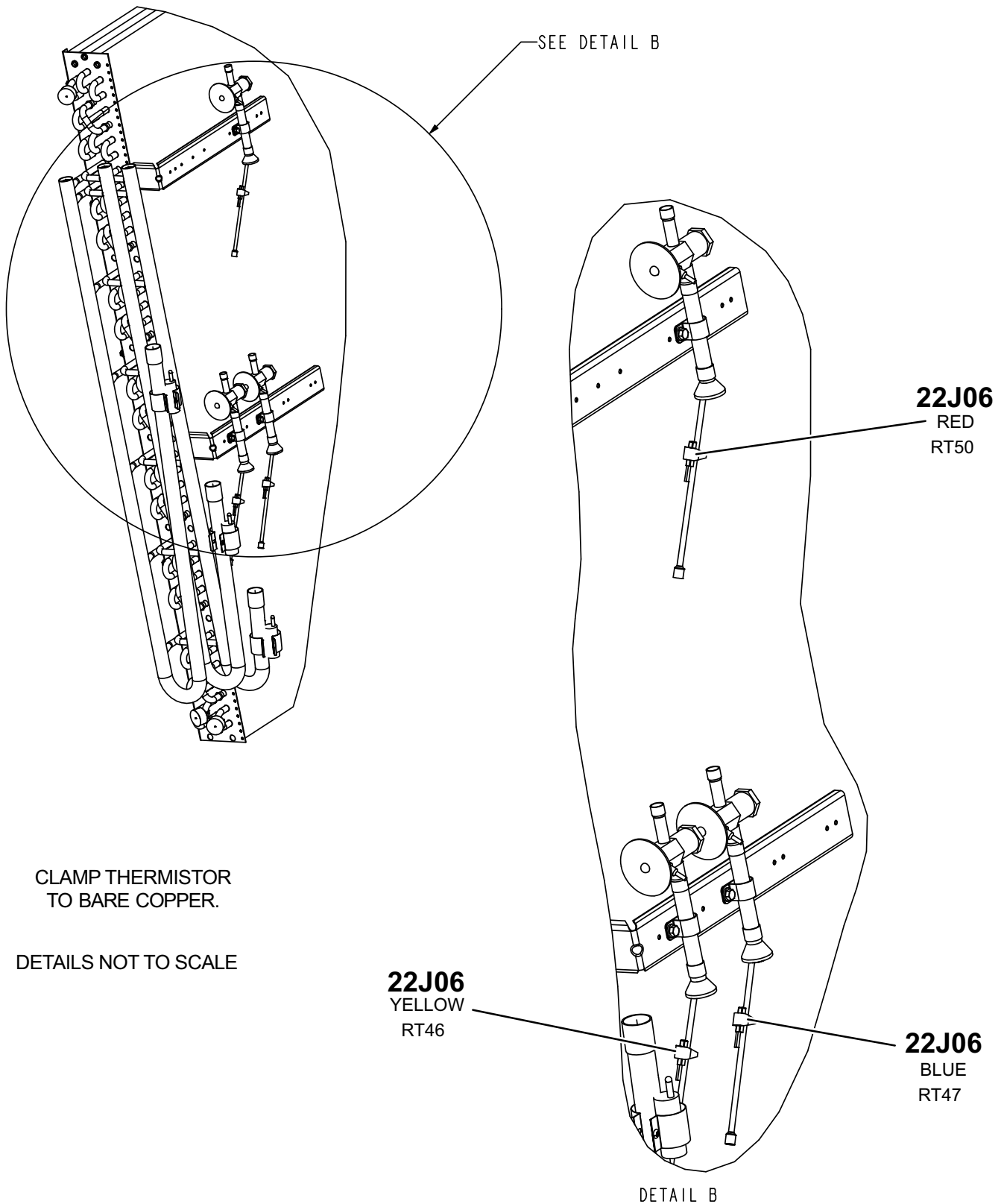

FIGURE 20

LGT/LCT210, 240, 300
EVAPORATOR COIL
RT46, 47, 50, 51

SEE DETAIL C

22J06
GREEN
RT51

22J06
RED
RT50

22J06
BLUE
RT47

22J06
YELLOW
RT46

CLAMP THERMISTOR
TO BARE COPPER.

DETAILS NOT TO SCALE

DETAIL C

FIGURE 21

LGT/LCT156
CONDENSER / OUTDOOR COIL
(RT48, 49)

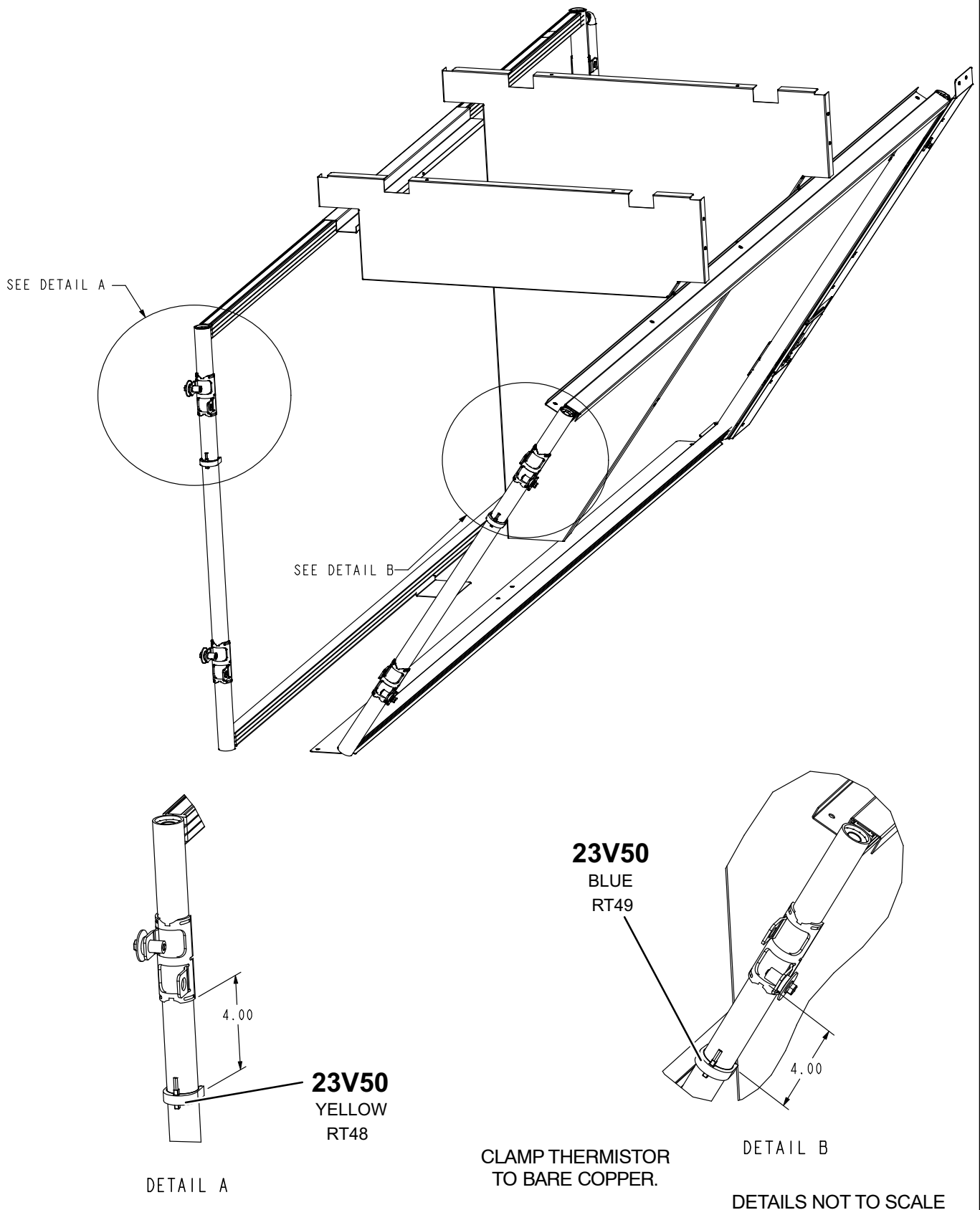
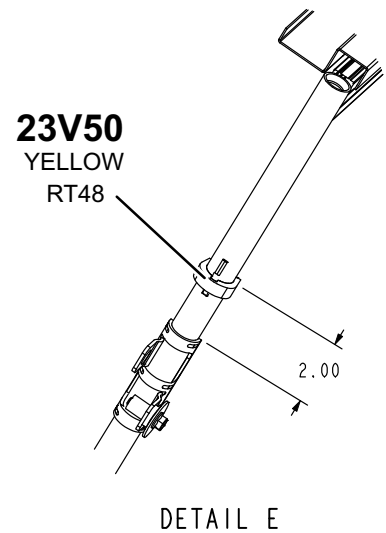
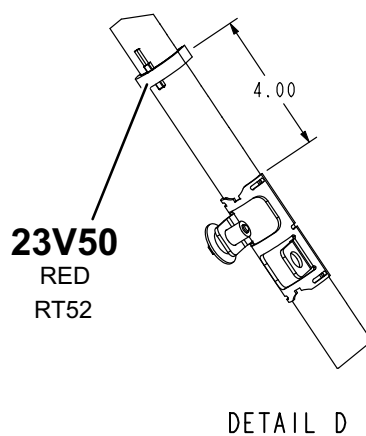
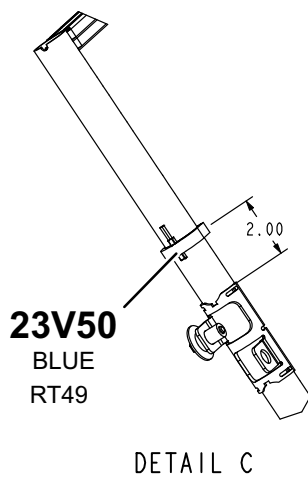
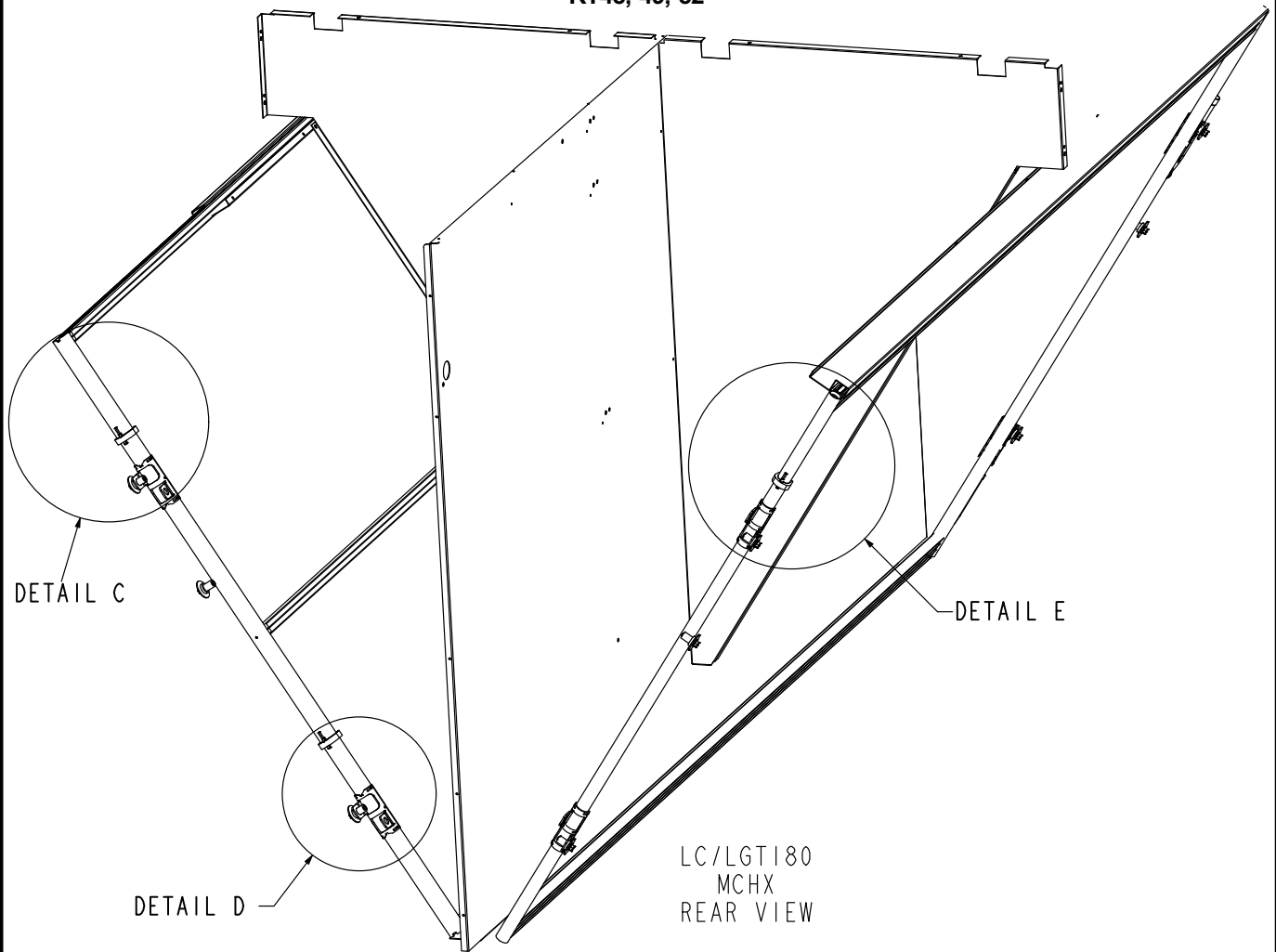

FIGURE 22

LGT/LCT180
CONDENSER / OUTDOOR COIL
RT48, 49, 52



DETAILS NOT TO SCALE

FIGURE 23

LGT/LCT210, 240, 300
CONDENSER / OUTDOOR COIL
RT48, 49, 52, 53

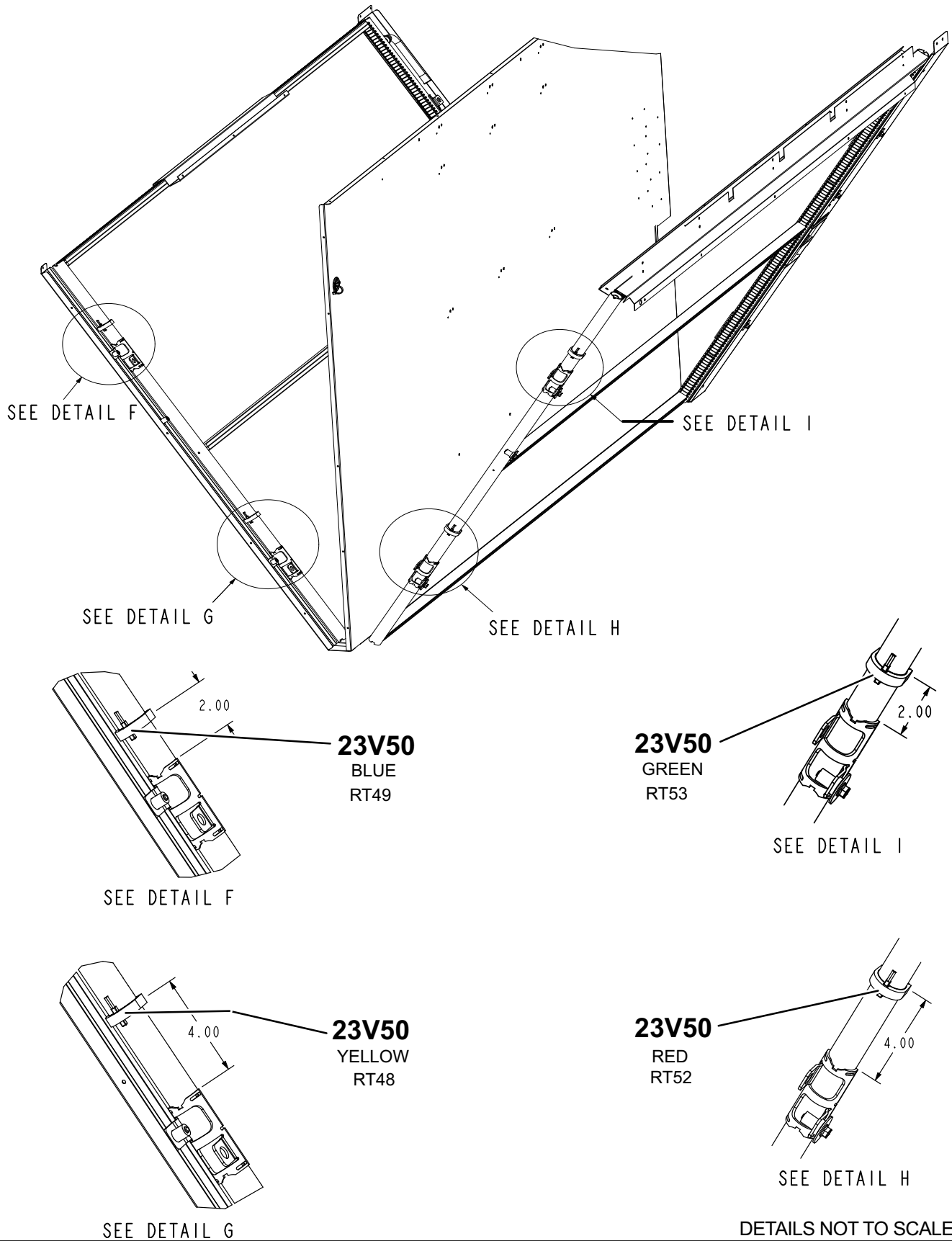
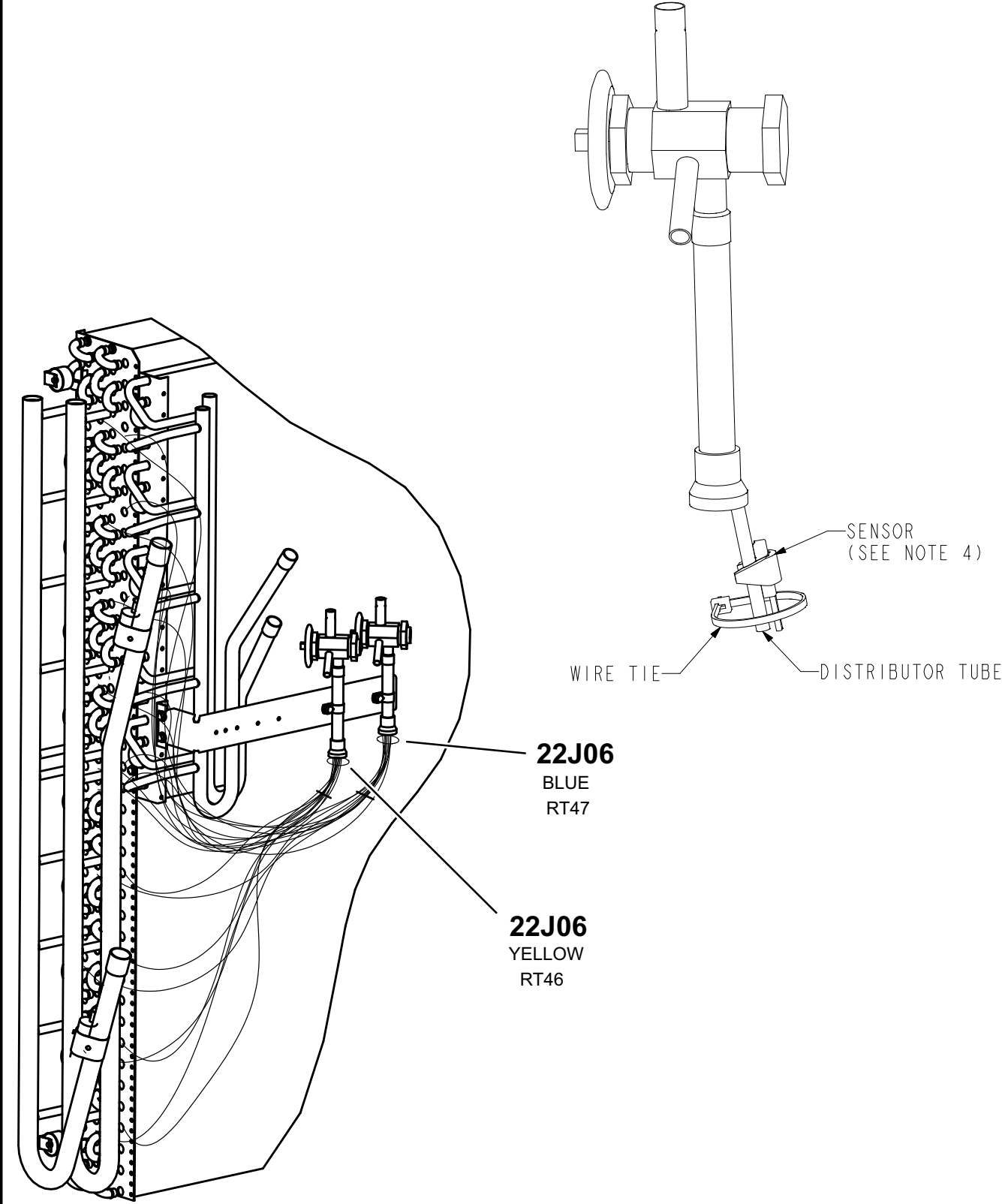

FIGURE 24

THERMISTOR LOCATION - LGT/LCT092, 102, 122, 150
EVAPORATOR COIL
RT46, RT47



DETAILS NOT TO SCALE

FIGURE 25
Page 26

LGT/LCT092, 102, 120, 150
CONDENSER COIL
RT48, RT49

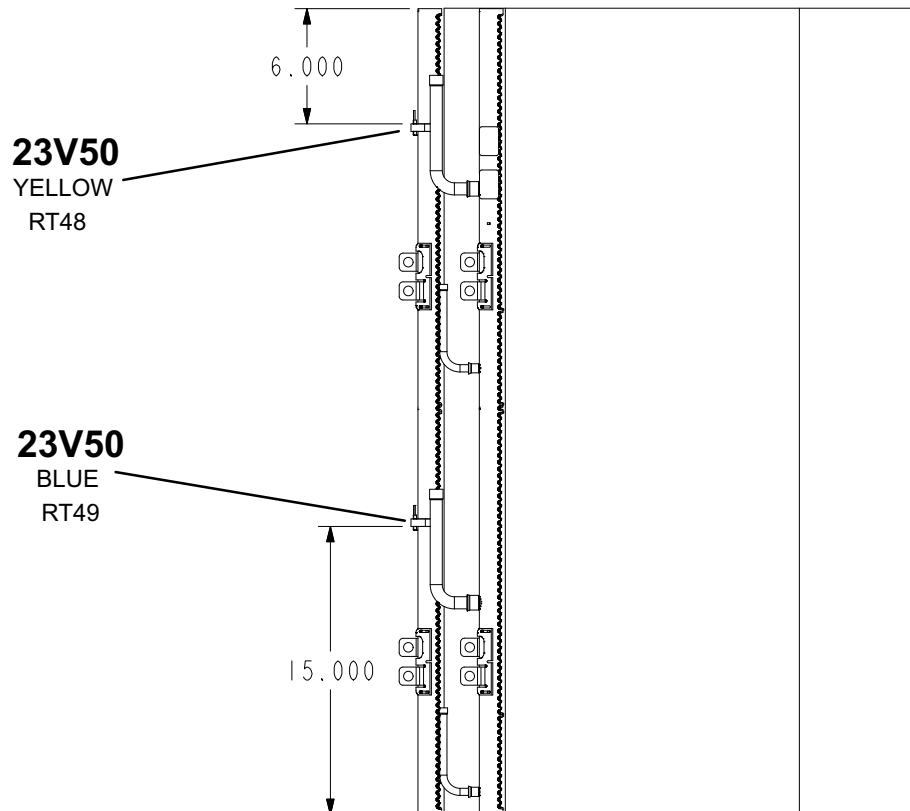
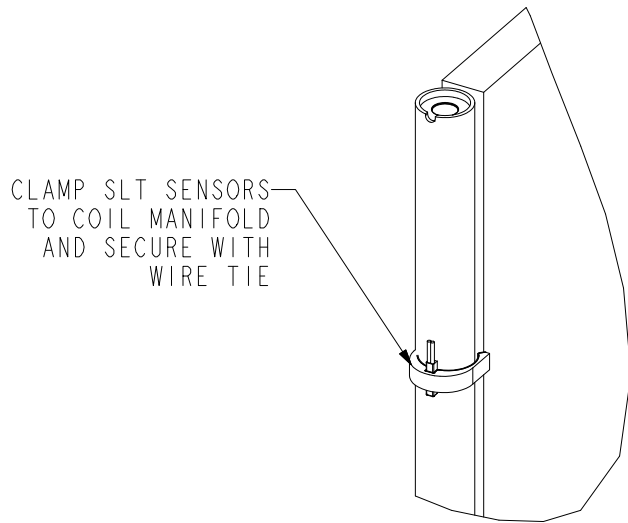

DETAILS NOT TO SCALE

FIGURE 26

LHT/LDT078, 092, 102, 122, 150
INDOOR COIL
RT46, RT47

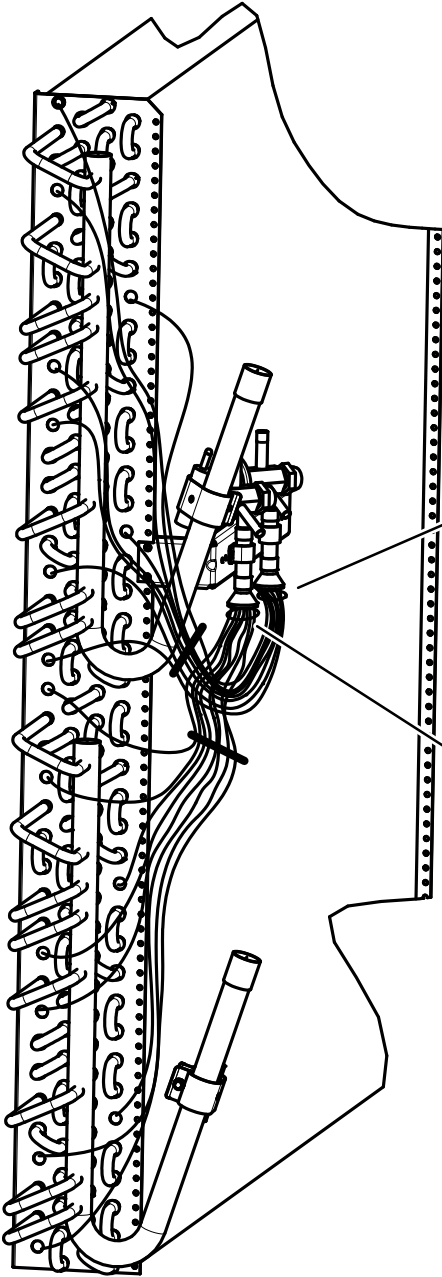

22J06
BLUE
RT47

22J06
YELLOW
RT46

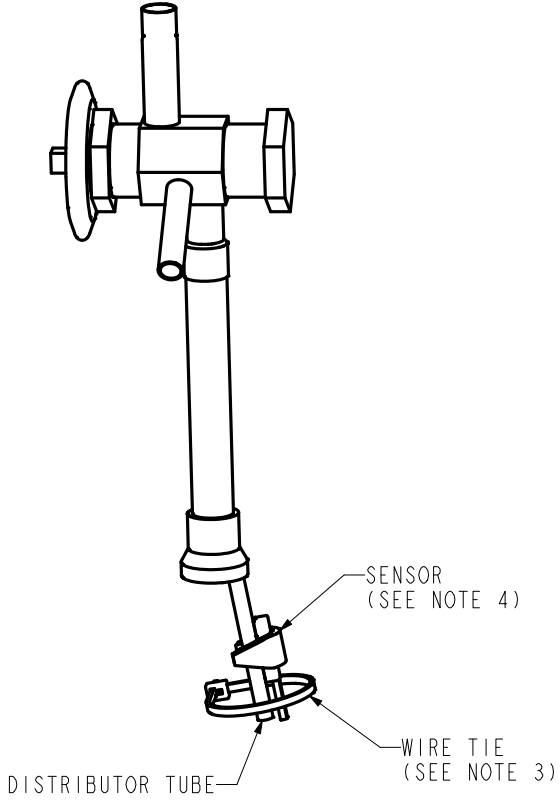

DETAILS NOT TO SCALE

FIGURE 27
Page 28

LHT/LDT078, 092, 102, 122, 150
CONDENSER COIL
RT48, RT49

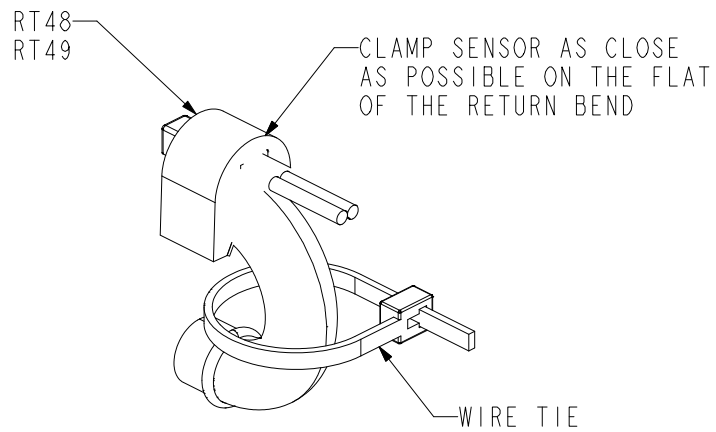

SENSOR DETAIL

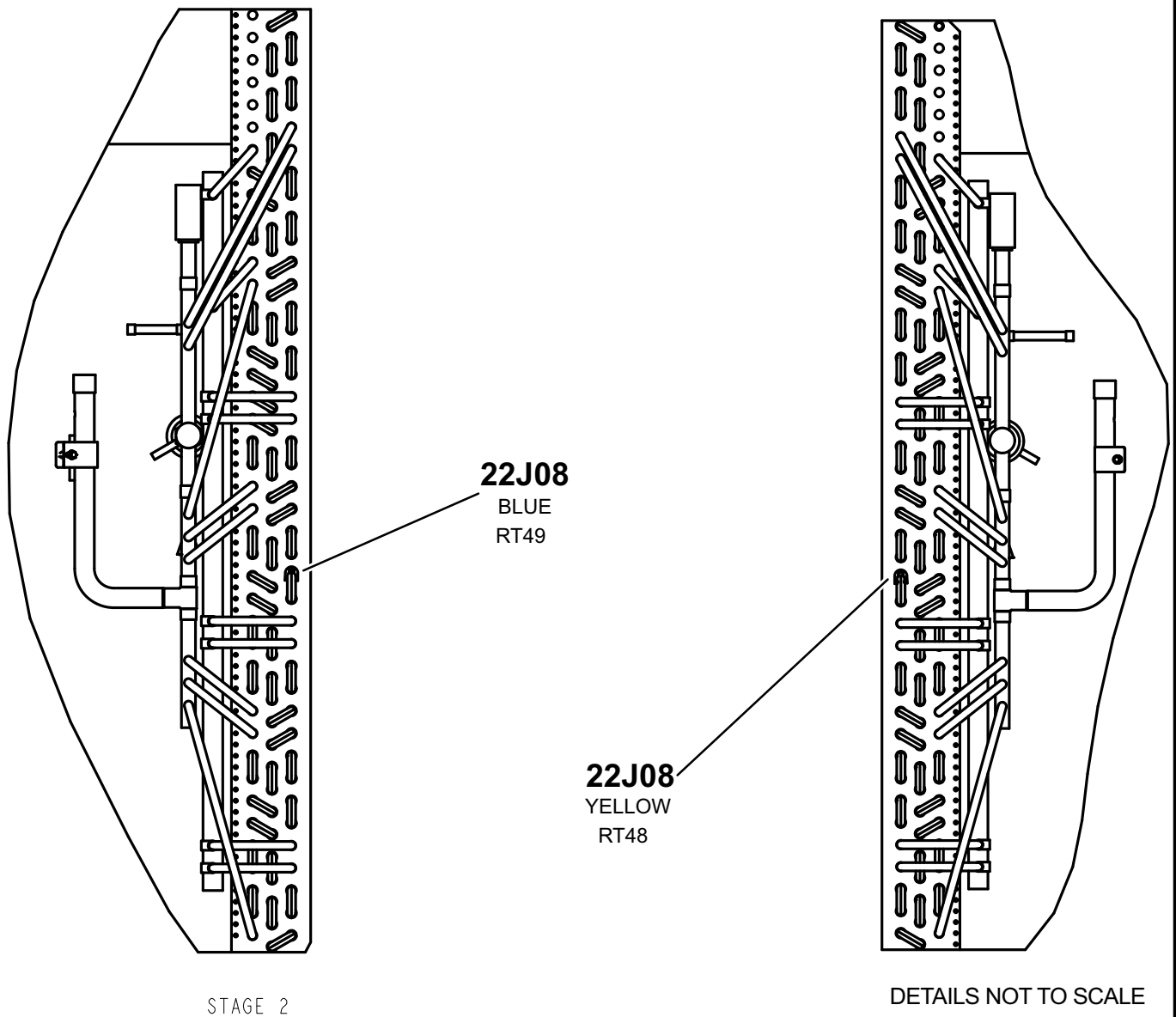

FIGURE 28

LHT/LDT156, 180, 240
INDOOR COIL
RT46, RT47

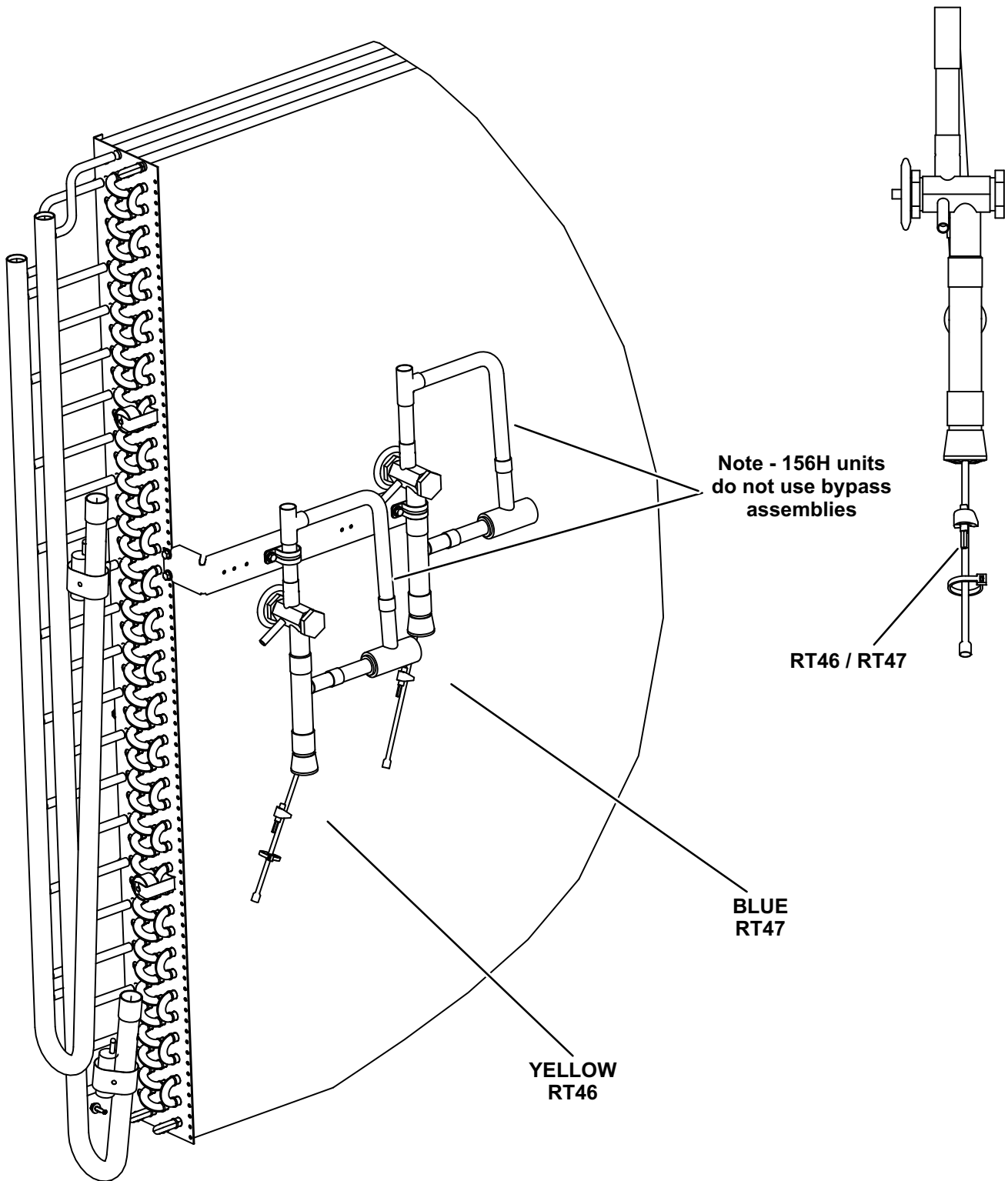

FIGURE 29

LHT/LDT156, 180, 240
OUTDOOR COIL
RT48, RT49

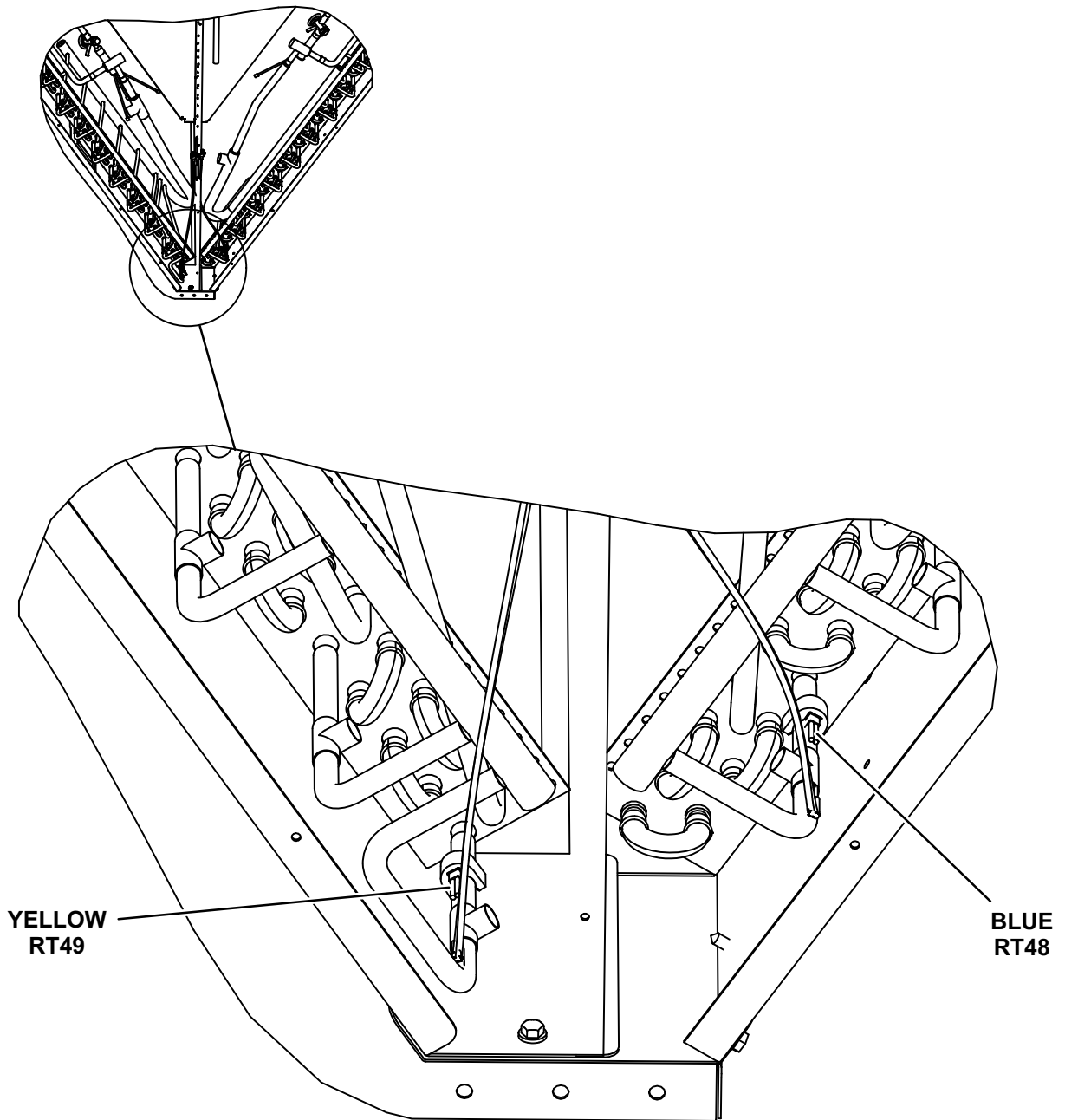

FIGURE 30