

# PACKAGED UNITS KITS AND ACCESSORIES

507673-01  
1/2017

## REHEAT VALVE REPLACEMENT KIT

### INSTALLATION INSTRUCTIONS FOR FOUR-WAY REHEAT VALVE REPLACEMENT KIT (15X86; 616030-01) USED WITH LGH/LCH036-300S REHEAT UNITS

#### Shipping and Packing List

Package 1 of 1 contains:

- 1- Four-way reheat valve
- 4- Copper tube assemblies

#### Application

This kit is used when replacing the FOUR-WAY reheat valve in LGH/LCH036-300S reheat units. This kit is NOT used to replace three-way valves in older units. See figure 1.

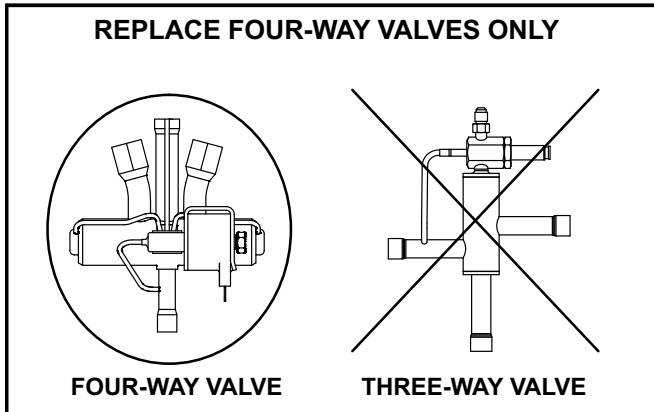

FIGURE 1

#### Identify Copper Tubing

- 1- Use figures 2, 3, and 4 to determine the unit appropriate copper tubing provided in kit. Discard unused tubing.
- 2- Disconnect all power to unit.

### ⚠️ WARNING

Improper installation, adjustment, alteration, service or maintenance can cause property damage, personal injury or loss of life. Installation and service must be performed by a licensed professional HVAC installer or equivalent, service agency, or the gas supplier

### ⚠️ CAUTION

As with any mechanical equipment, contact with sharp sheet metal edges can result in personal injury. Take care while handling this equipment and wear gloves and protective clothing.

- 3- Using approved methods, recover all refrigerant from system.

### ⚠️ IMPORTANT

The Clean Air Act of 1990 bans the intentional venting of refrigerant (CFC's and HCFC's) as of July 1, 1992. Approved methods of recovery, recycling or reclaiming must be followed. Fines and/or incarceration may be levied for non-compliance.

**A BOX PLUMBING**  
036-074

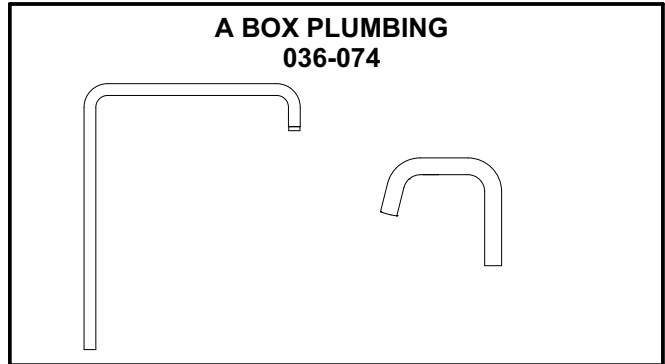

FIGURE 2

**B BOX PLUMBING**  
092-150

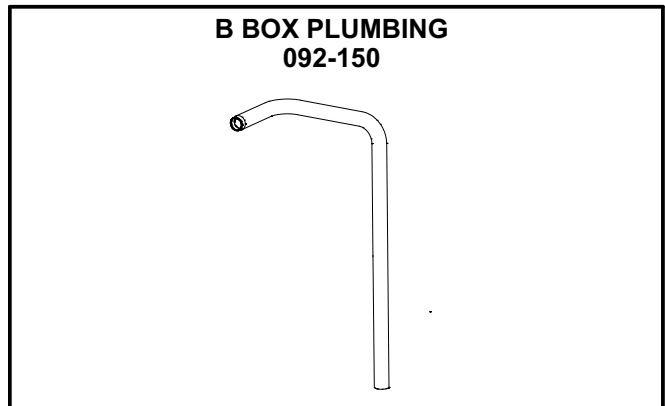

FIGURE 3

**C BOX PLUMBING**  
156-300

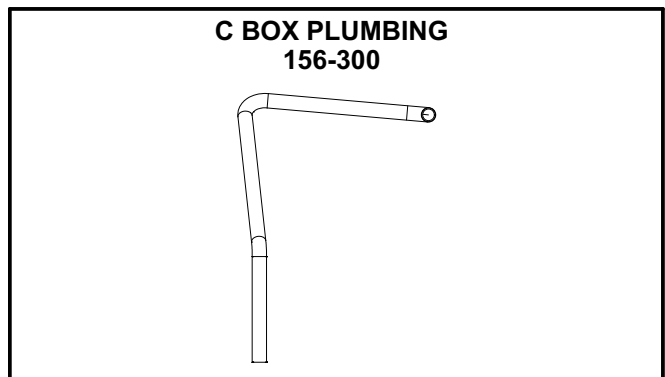
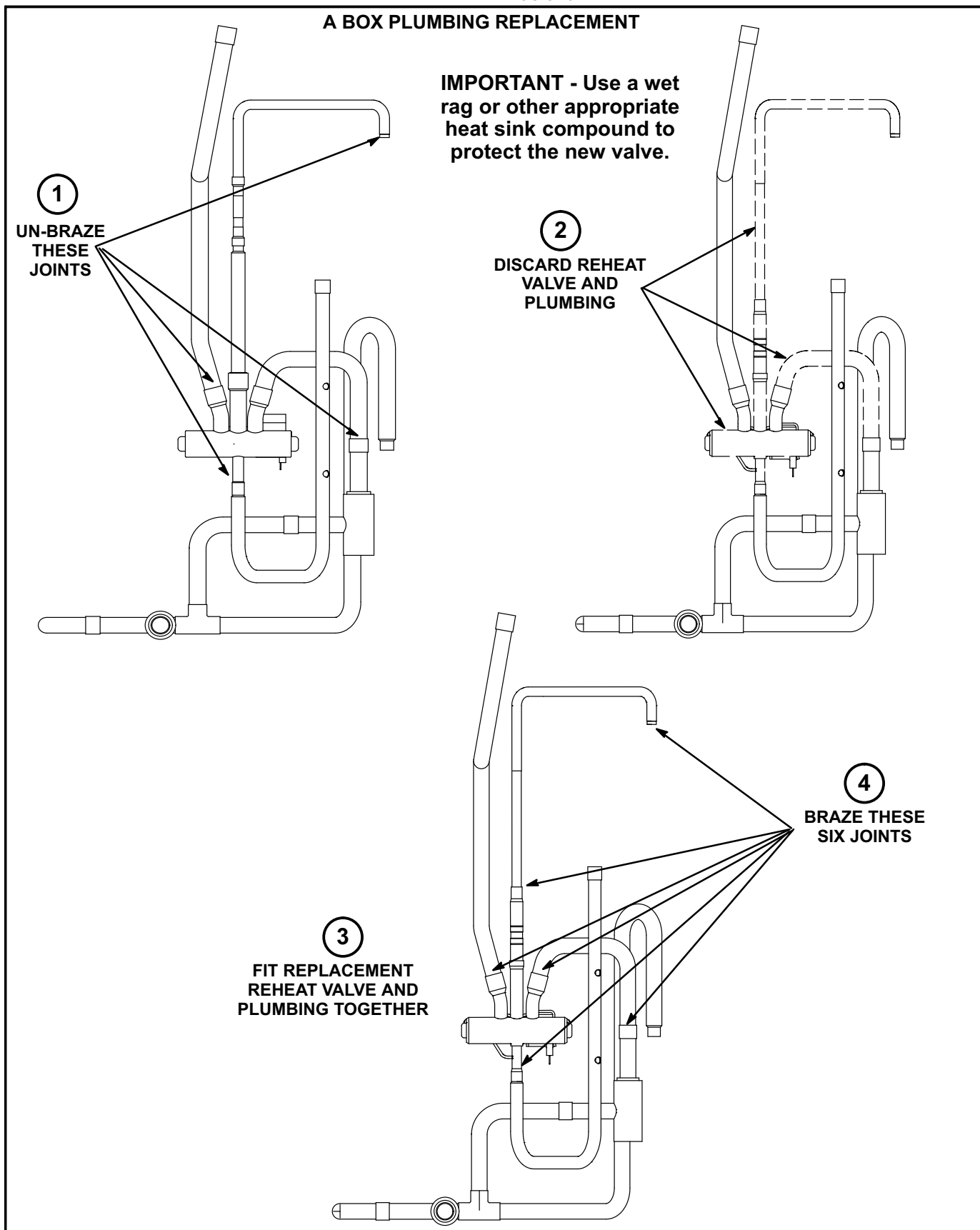

FIGURE 4



Unsweat plumbing as shown in figure 5. Fit reheat valve and appropriate plumbing from kit into place. Braze joints as shown.



**FIGURE 5**

Unswear plumbing as shown in figure 6. Fit reheat valve and appropriate plumbing from kit into place. Braze joints as shown.

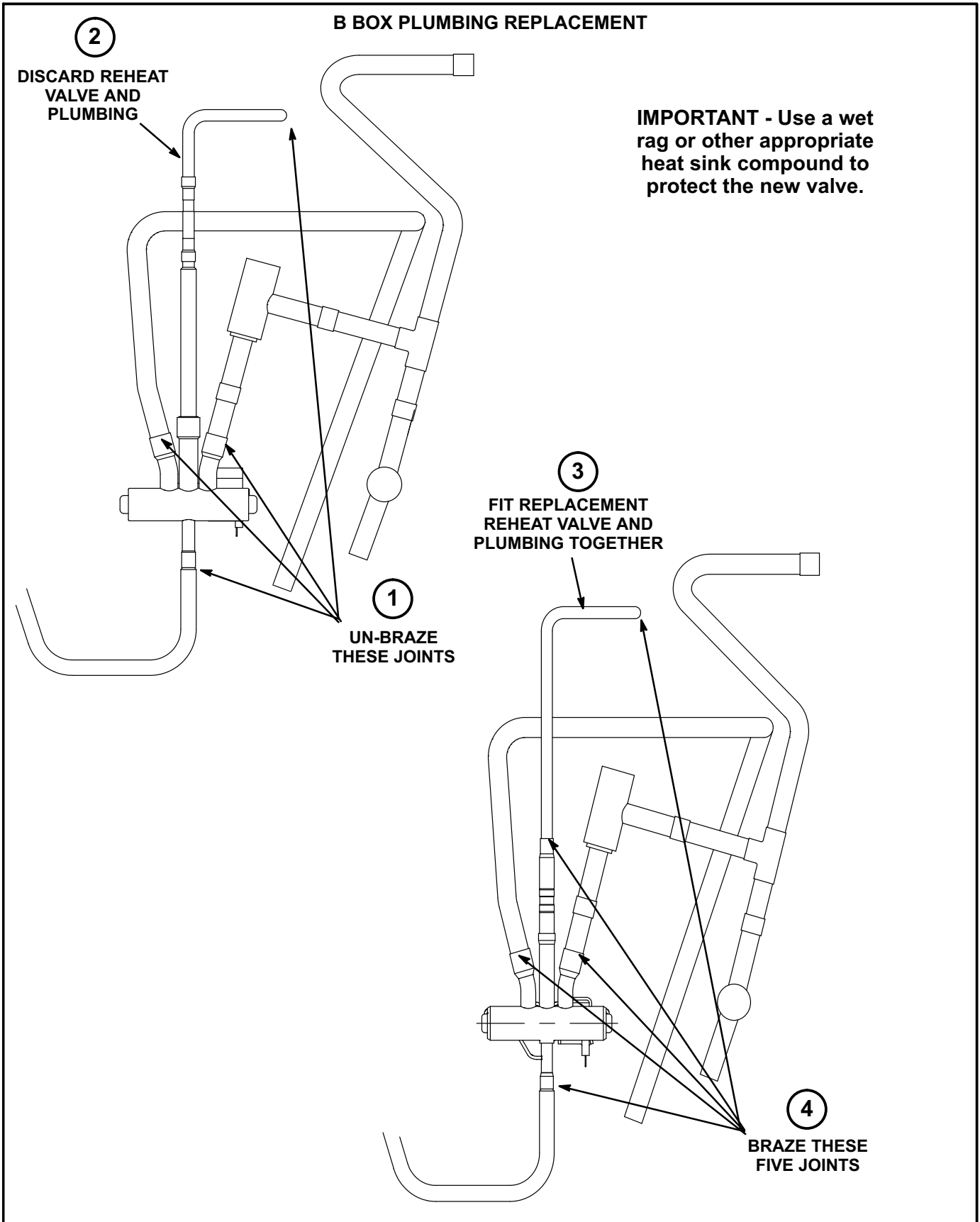

**FIGURE 6**

**C Box Units - 156-300**

Unswear plumbing as shown in figure 7. Fit reheat valve and appropriate plumbing from kit into place. Braze joints as shown.

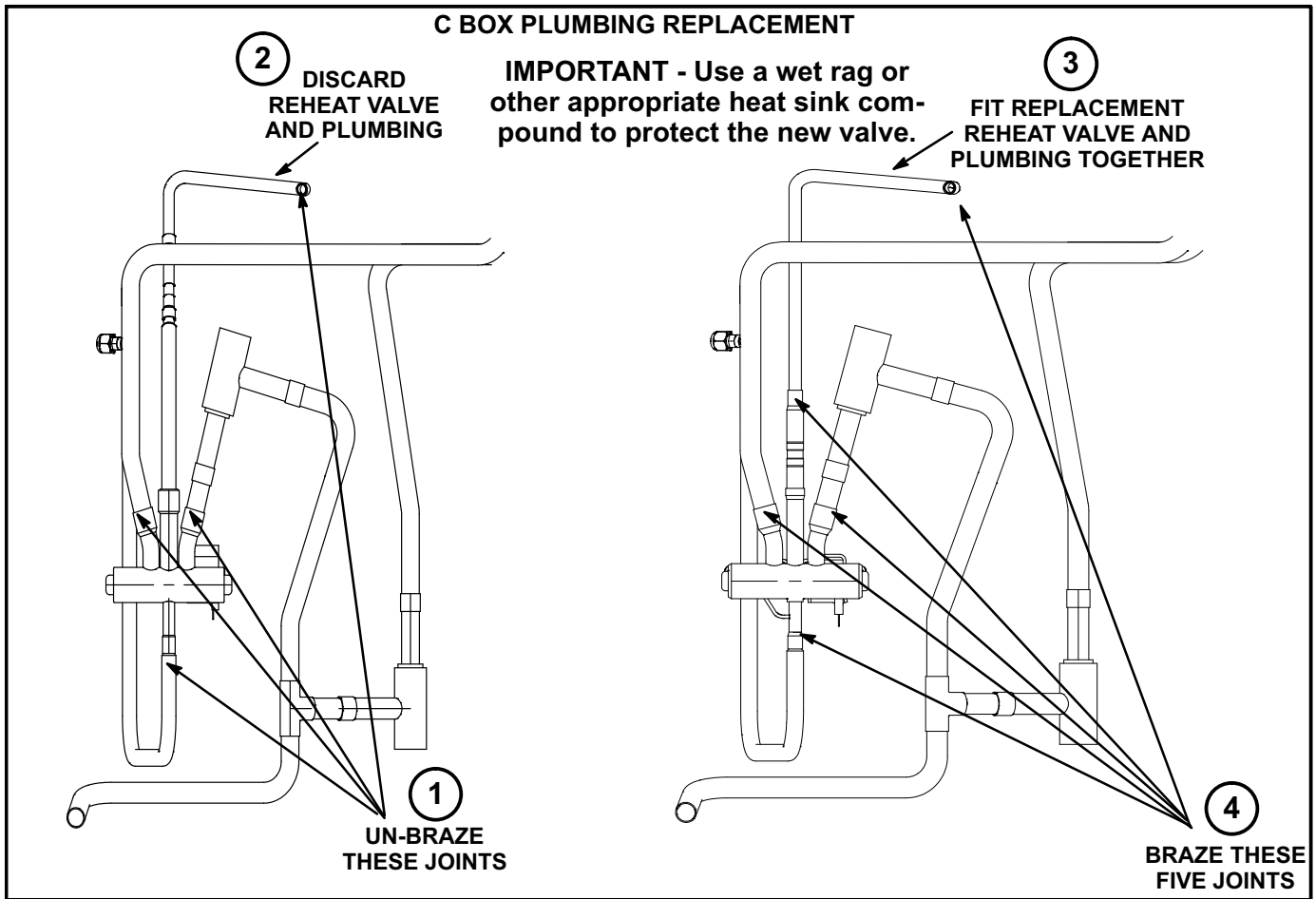

FIGURE 7

**Leak Test / Evacuate / Charge**

Pressurize system with dry nitrogen and check for leaks. Evacuate system and charge according to charging procedure sticker on unit or unit installation instruction.

**⚠ WARNING**



**Danger of explosion. Can cause injury, death or equipment damage.**

**Do not use oxygen to pressurize the refrigerant system. Oxygen and oil can combine to cause an explosion.**

**⚠ CAUTION**

**Danger of equipment damage.**

**Avoid deep vacuum operation. Do not use compressors to evacuate a system. Extremely low vacuums can cause internal arcing and compressor failure.**

**Damage caused by deep vacuum operation will void the warranty.**

**⚠ CAUTION**

**Danger of equipment damage.**

**Be sure to attach vacuum pump to BOTH discharge and suction lines. Failure to do so may result in an incomplete vacuum and compressor damage.**

**⚠ IMPORTANT**

**Crankcase heater should be energized 24 hours before unit start-up to prevent compressor damage as a result of slugging.**