

DRIP SHIELD REPLACEMENT KIT

INSTALLATION INSTRUCTIONS FOR DRIP SHIELD REPLACEMENT KIT (80W00; 606902-01) USED ON LGH/LCH420-600 PACKAGED UNITS

Shipping and Packing List

Package 1 of 1 contains:

- 1- Drip Shield
- 2- Straps
- 2- Mounting brackets
- 1- Bag assembly containing:
 - 12-#10 3/8" Sheet metal screws
 - 2-#10 5/8" Self drilling screws

Application

This kit is used to replace the drip shield on the upper plastic drain pan.

⚠ WARNING

Improper installation, adjustment, alteration, service or maintenance can cause property damage, personal injury or loss of life. Installation and service must be performed by a qualified installer, service agency or the gas supplier

⚠ CAUTION

Danger of sharp metallic edges. Can cause injury. Take care when servicing unit to avoid accidental contact with sharp edges.

Installation

- 1- Disconnect all power and open blower access panels. See figure 1. Locate the rear mullion to the right of the blower access panel. Remove the screw securing the bottom of the mullion; remove mullion.
- 2- Remove three drip shields and three brackets as shown in figure 2 and 3. Discard or retain parts as shown.

Note - Do not remove drain pan; drain pan will be supported by flanges on both ends.

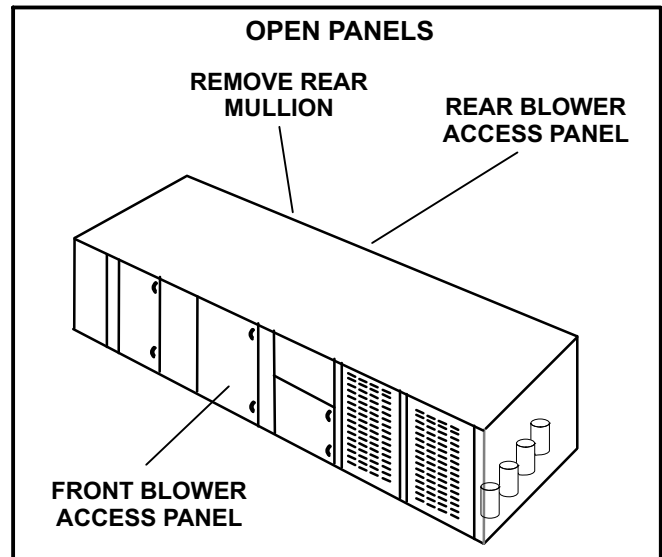

FIGURE 1

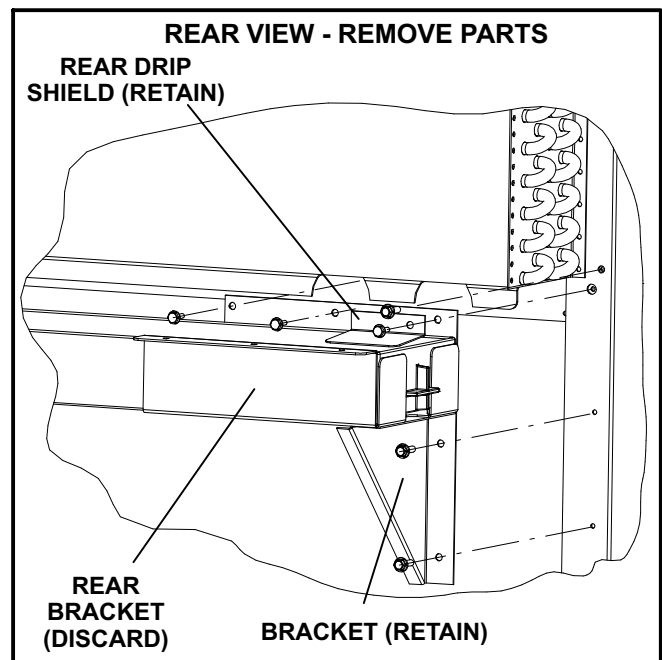

FIGURE 2



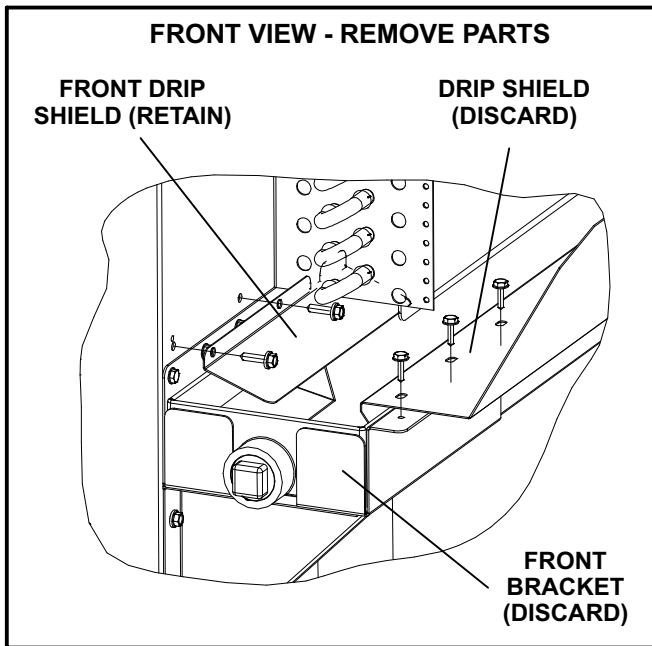

FIGURE 3

- 3- Install the rear bracket provided in kit. See figure 4.
- 4- Reinstall the retained rear drip shield and bracket.
- 5- Secure the rear strap, provided in kit, to the evaporator coil end plate.

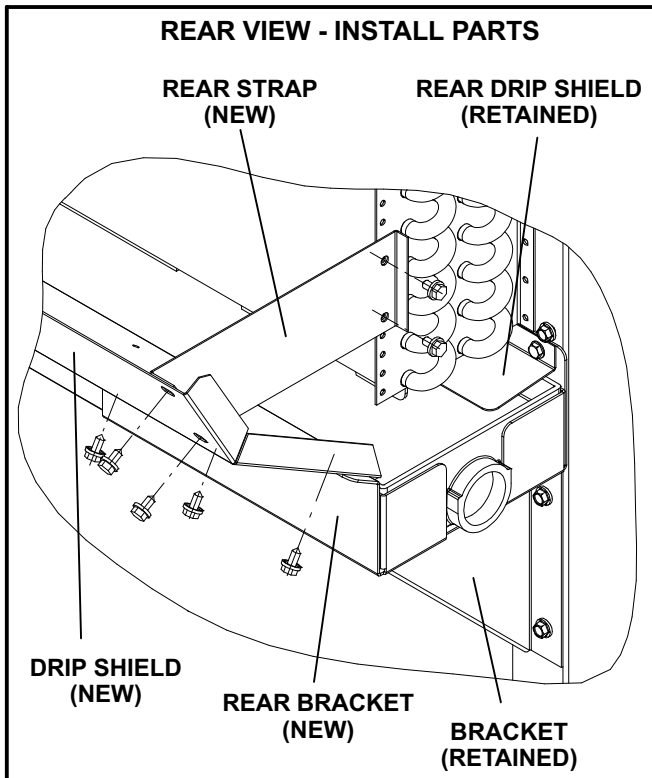

FIGURE 4

- 6- Install the front bracket provided in kit. See figure 5.
- 7- Reinstall the retained front drip shield.
- 8- Secure the front strap, provided in kit, to the evaporator coil end plate.
- 9- Install the new drip shield and secure to the front and rear strap. See figure 4 and 5.
- 10- Replace panels and restore power to unit.

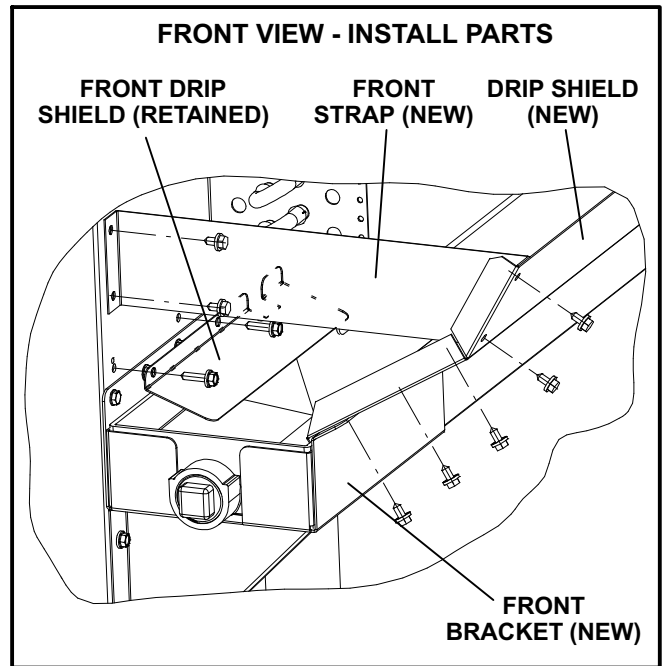

FIGURE 5